

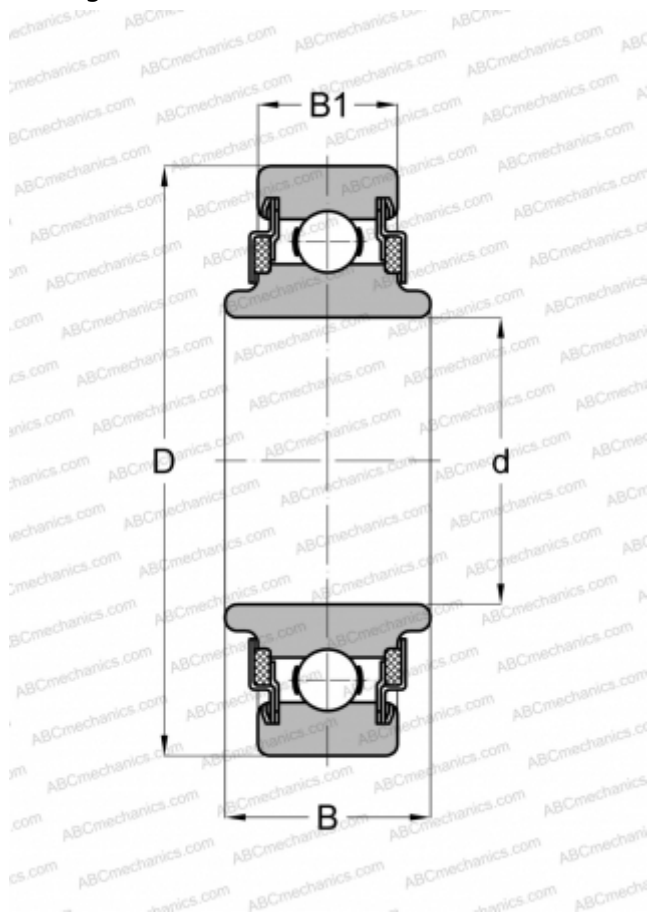

88504 NEW DEPARTURE

TYPE: Ball bearings, Radial ball bearings, Single row, Without flange, Felt seals on both side, wide inner ring



Technical specification

DIMENSIONS, MM

d	20,000
D	47,000
B	17,755
B1	13,995

WEIGHT, KG 0,117

MANUFACTURER

[NEW](#)
[DEPARTURE](#)