

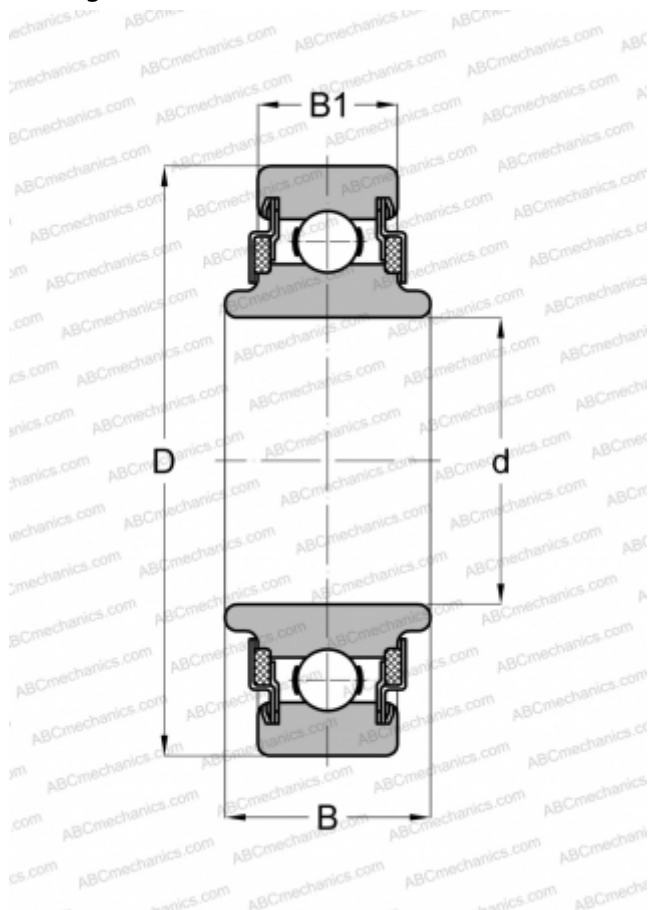

88505 NEW DEPARTURE

TYPE: Ball bearings, Radial ball bearings, Single row, Without flange, Felt seals on both side, wide inner ring



Technical specification

DIMENSIONS, MM

d	25,000
D	52,000
B	16,739
B1	15,011

WEIGHT, KG 0,138

MANUFACTURER

[NEW](#)
[DEPARTURE](#)