

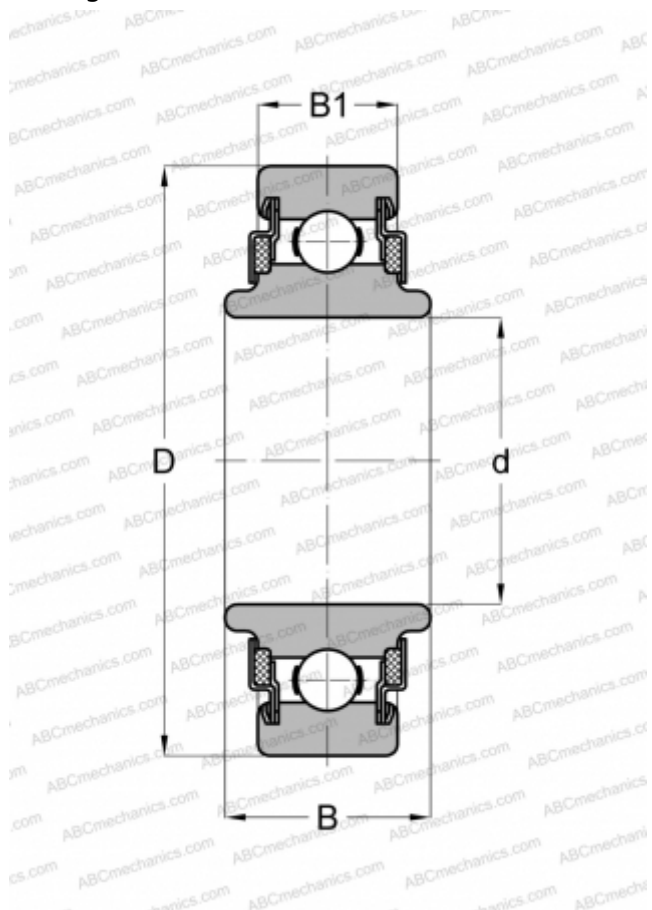

88107 NEW DEPARTURE

TYPE: Ball bearings, Radial ball bearings, Single row, Without flange, Felt seals on both side, wide inner ring



Technical specification

DIMENSIONS, MM

d	35,000
D	72,000
B	24,994
B1	16,993

WEIGHT, KG 0,347

MANUFACTURER

[NEW](#)
[DEPARTURE](#)