

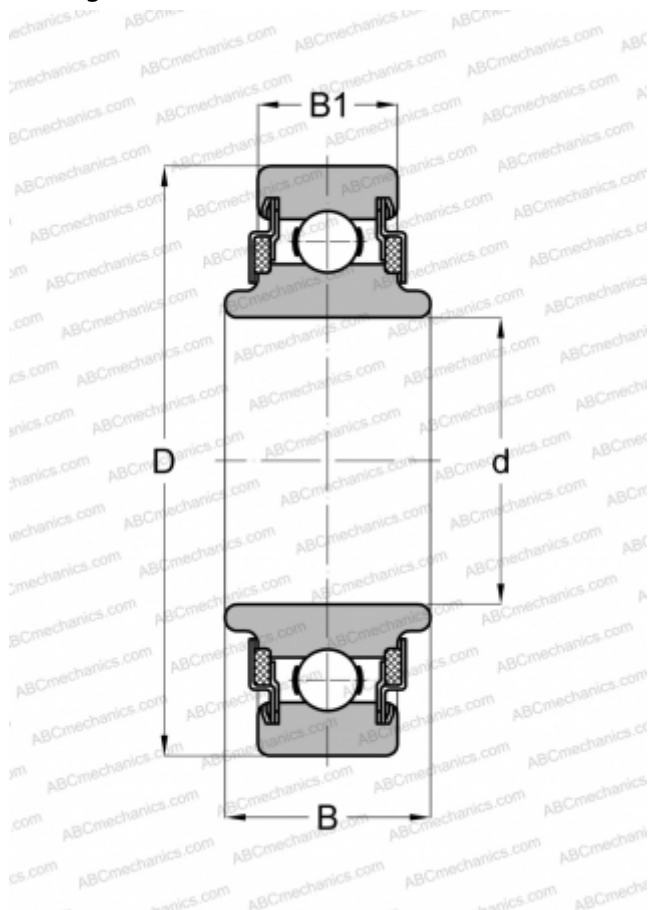

88510 NEW DEPARTURE

TYPE: Ball bearings, Radial ball bearings, Single row, Without flange, Felt seals on both side, wide inner ring



Technical specification

DIMENSIONS, MM

d	50,000
D	90,000
B	29,997
B1	21,996

WEIGHT, KG 0,635

MANUFACTURER

[NEW](#)
[DEPARTURE](#)

