

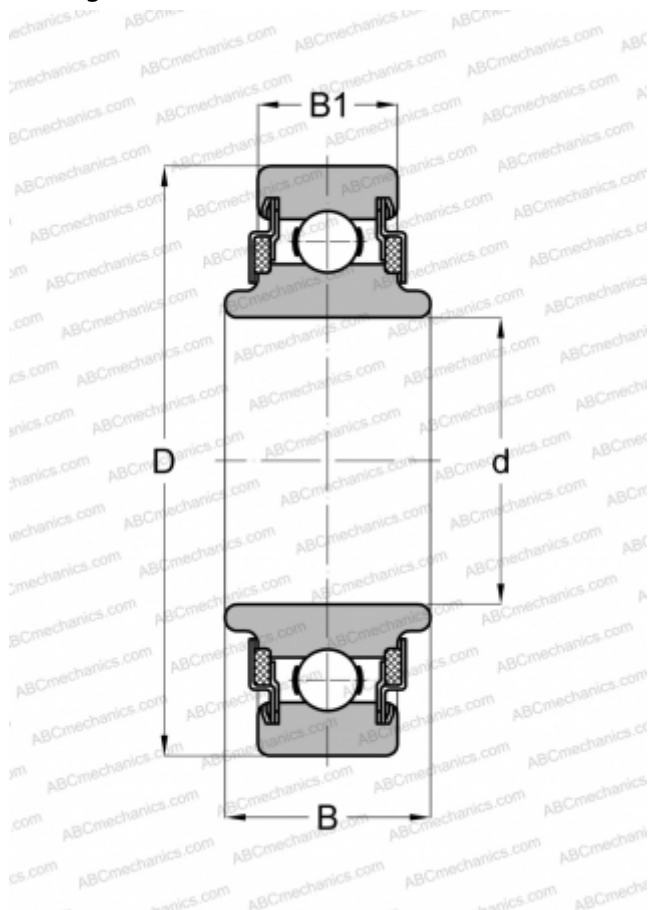

## 88511 NEW DEPARTURE

TYPE: Ball bearings, Radial ball bearings, Single row, Without flange, Felt seals on both side, wide inner ring



### Technical specification

#### DIMENSIONS, MM

d	55,000
D	100,000
B	30,988
B1	23,012

WEIGHT, KG 0,807

#### MANUFACTURER

[NEW](#)  
[DEPARTURE](#)

