

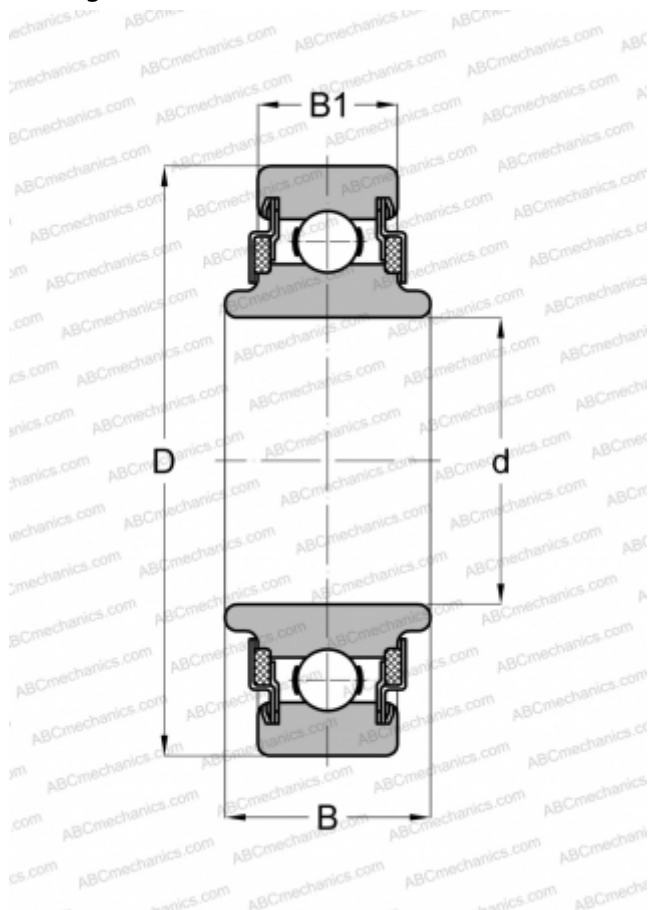

88513 NEW DEPARTURE

TYPE: Ball bearings, Radial ball bearings, Single row, Without flange, Felt seals on both side, wide inner ring



Technical specification

DIMENSIONS, MM

d	65,000
D	120,000
B	35,992
B1	26,010

WEIGHT, KG 1,383

MANUFACTURER

[NEW](#)
[DEPARTURE](#)

