

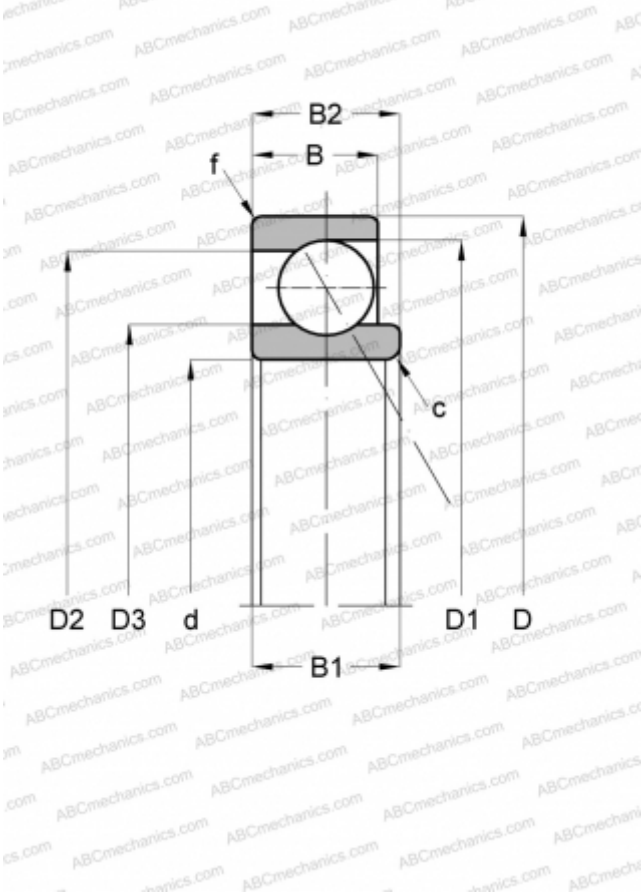

CPM 2708 CPM

Angular contact ball bearings

TYPE: Ball bearings, Angular contact ball bearing, Single row, Special, CPM production



Technical specification

DIMENSIONS, MM	
d	304,800
D	402,000
D1	384,800
D2	367,000
D3	340,000
B	38,000
B1	50,800
B2	50,800
f	1,000
c	5,500
α	30,000

MANUFACTURER [CPM](#)

