

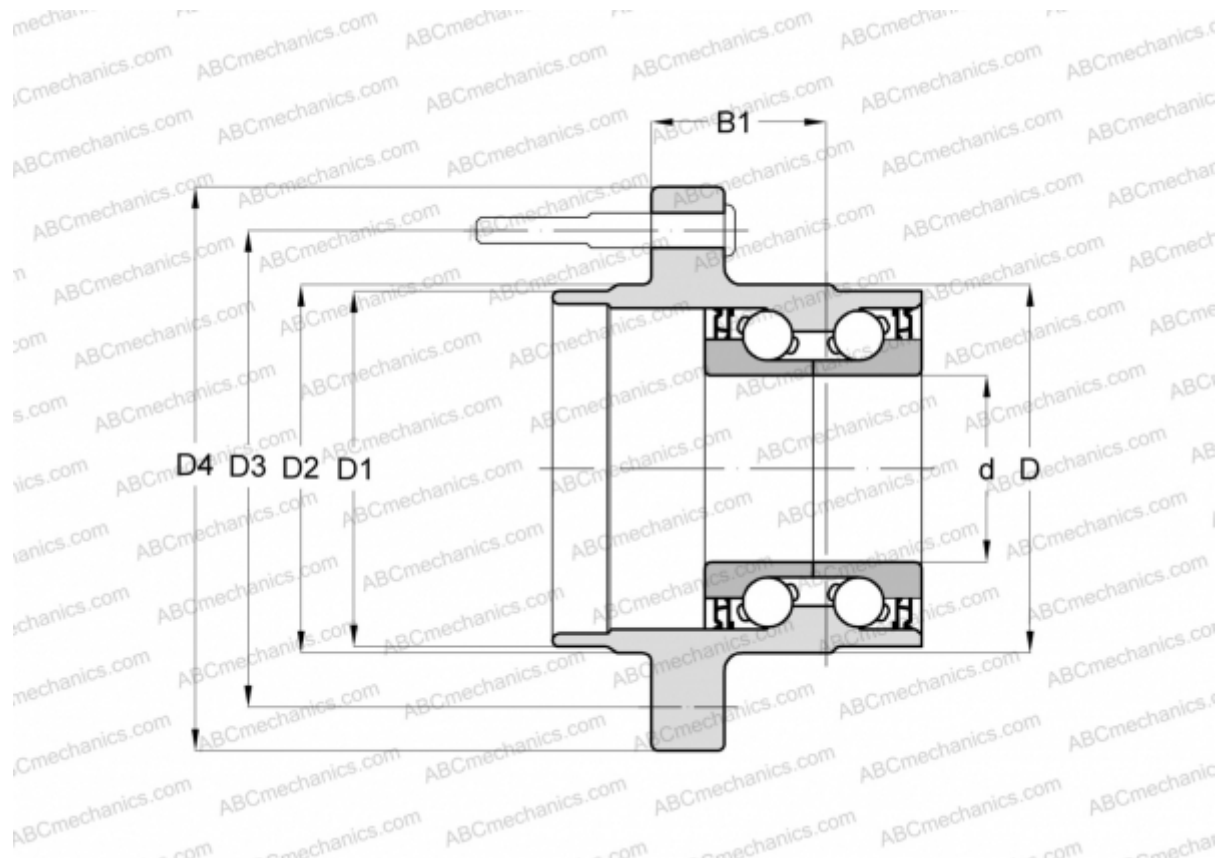

101053 FAG

Angular contact ball bearings

TYPE: Ball bearings, Angular contact ball bearing, Double row, Hub bearing (unit), FAG production, generation 2



Technical specification

DIMENSIONS, MM

d	43,000
D	83,500
D1	83,000
D2	82,800
D3	102,000
B1	44,000

MANUFACTURER

[FAG](#)

