

101150 FAG

Angular contact ball bearings

TYPE: Ball bearings, Angular contact ball bearing, Double row, Hub bearing (unit), FAG production, generation 2

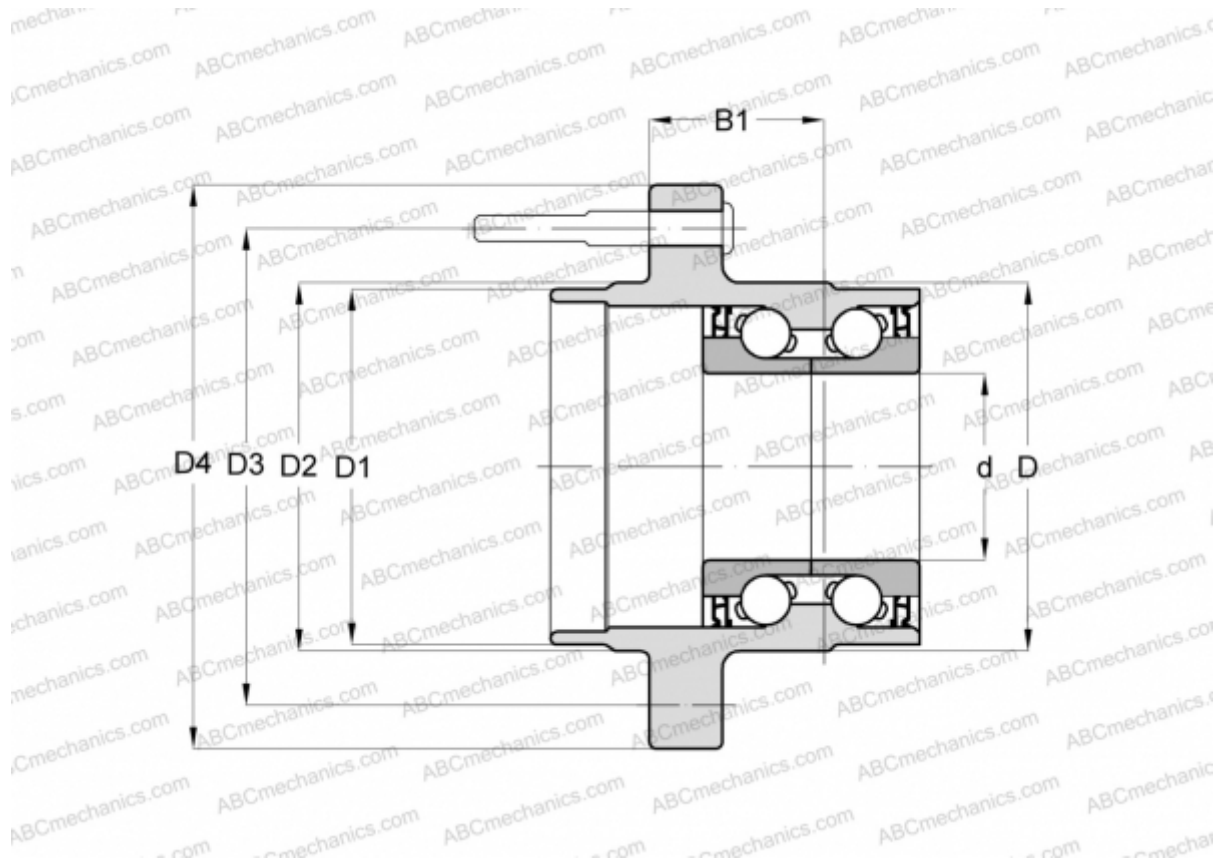

Technical specification

DIMENSIONS, MM

d	25,000
D	79,100
D1	60,000
D2	65,950
D3	100,000
D4	132,000
B1	54,000

MANUFACTURER

[FAG](#)