

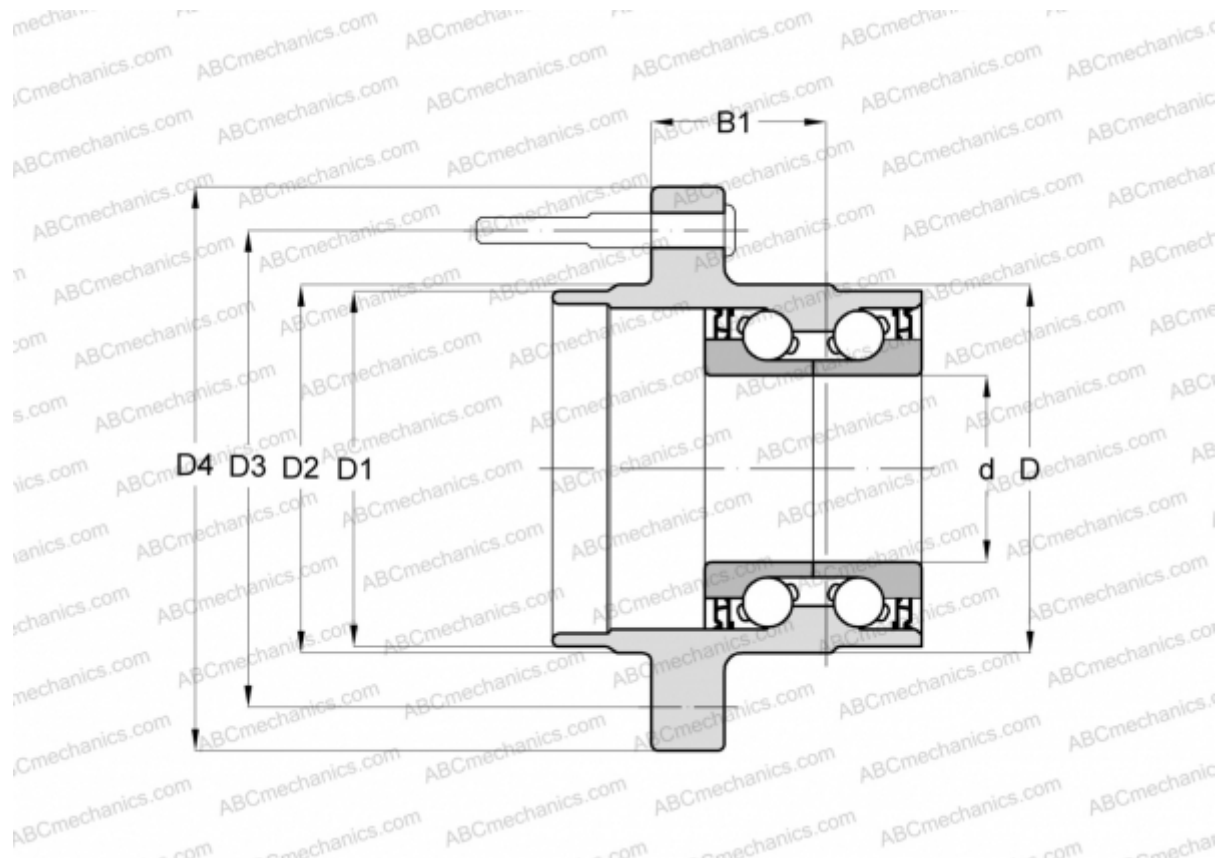

101872 FAG

Angular contact ball bearings

TYPE: Ball bearings, Angular contact ball bearing, Double row, Hub bearing (unit), FAG production, generation 2



Technical specification

DIMENSIONS, MM

| | |
|----|---------|
| d | 44,000 |
| D | 100,000 |
| D1 | 85,000 |
| D2 | 85,000 |
| D3 | 140,000 |
| D4 | 154,000 |
| B1 | 67,000 |

MANUFACTURER

[FAG](#)

