

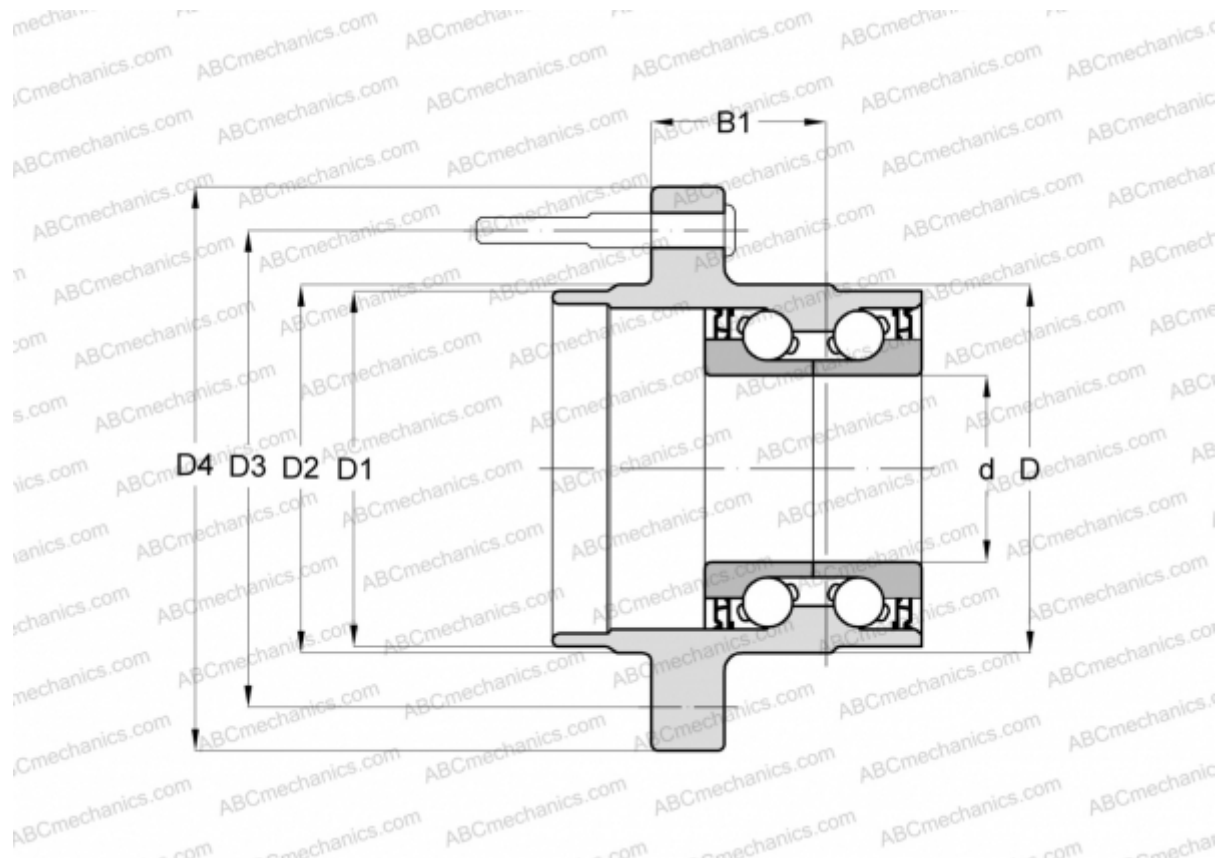

101994 FAG

Angular contact ball bearings

TYPE: Ball bearings, Angular contact ball bearing, Double row, Hub bearing (unit), FAG production, generation 2



Technical specification

DIMENSIONS, MM

d	42,000
D	120,000
D1	71,400
D2	73,300
D3	114,300
D4	160,000
B1	57,800

MANUFACTURER

[FAG](#)

