

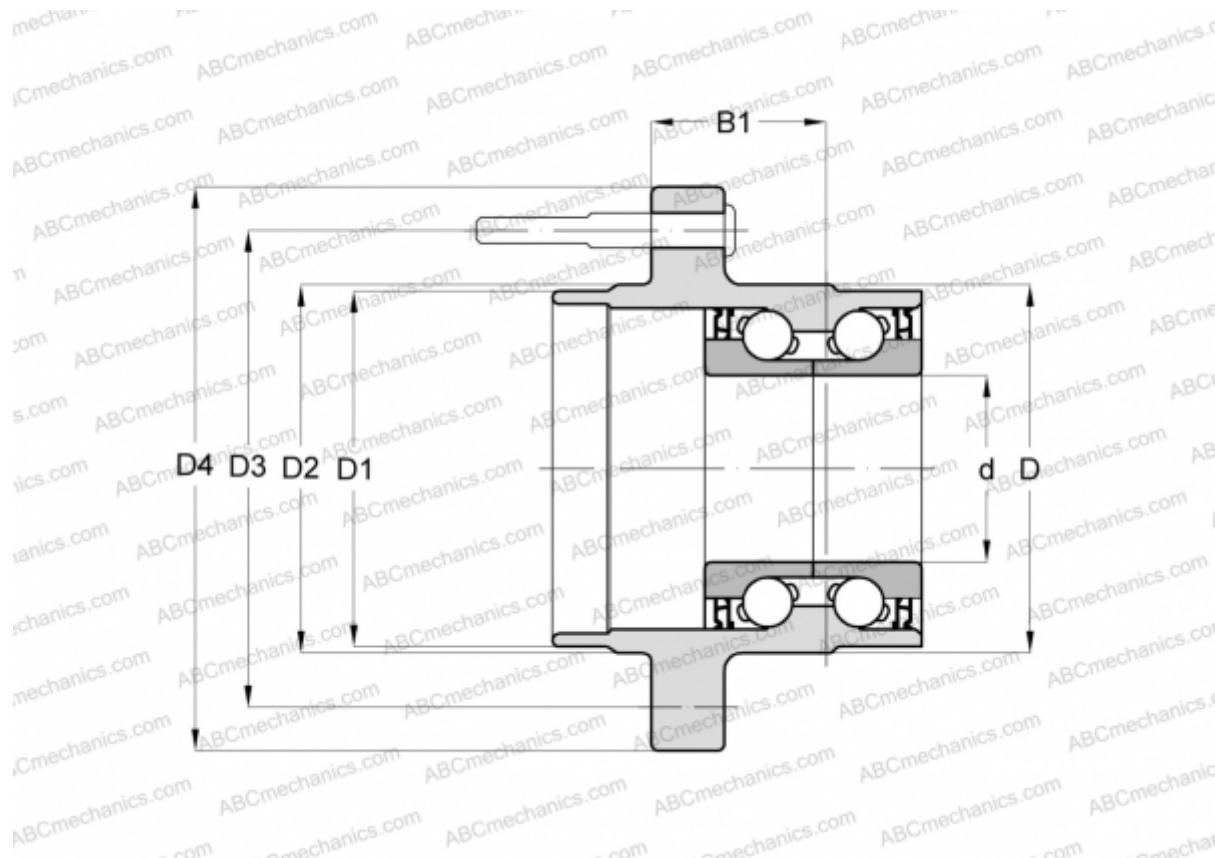

102086 FAG

Angular contact ball bearings

TYPE: Ball bearings, Angular contact ball bearing, Double row, Hub bearing (unit), FAG production, generation 2



Technical specification

DIMENSIONS, MM

d	30,000
D	66,000
D1	56,100
D2	61,000
D3	100,000
D4	138,700
B1	56,000

MANUFACTURER

[FAG](#)

