

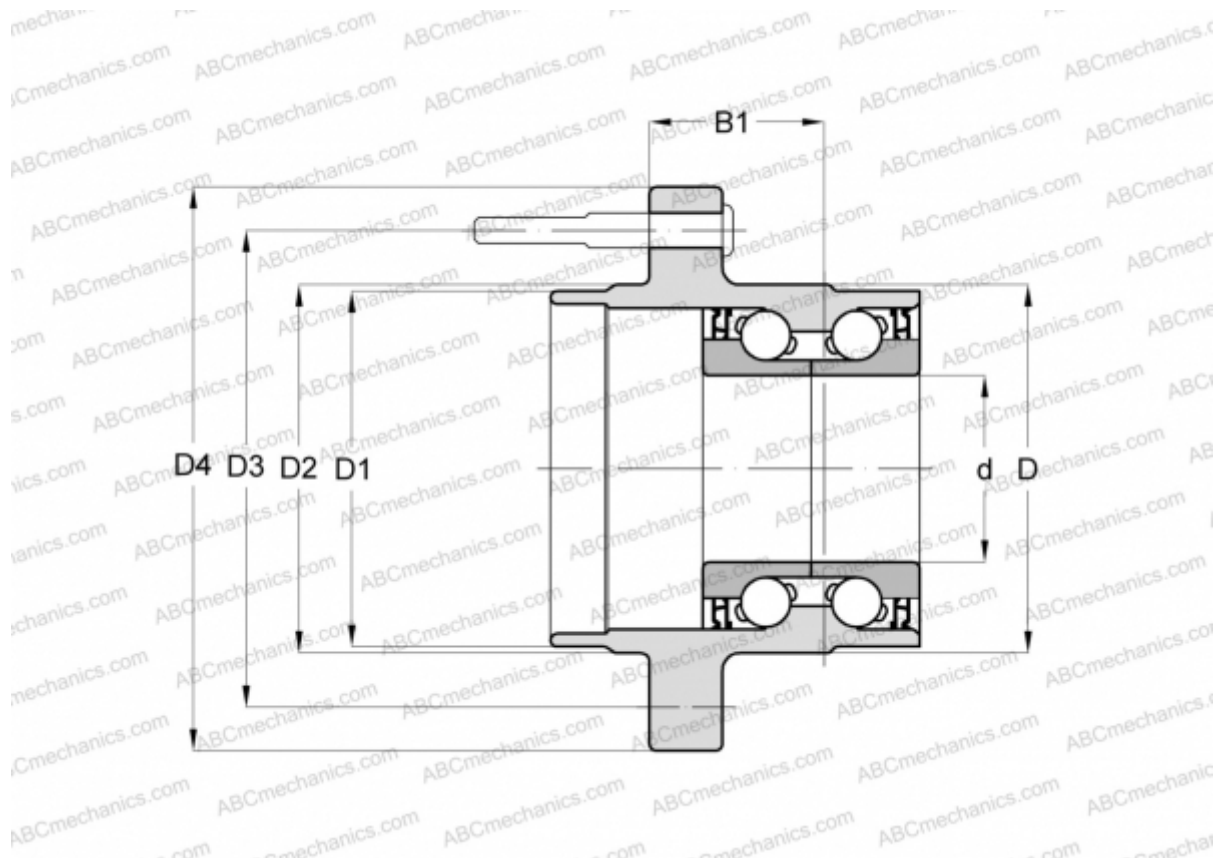

102119 FAG

Angular contact ball bearings

TYPE: Ball bearings, Angular contact ball bearing, Double row, Hub bearing (unit), FAG production, generation 2



Technical specification

DIMENSIONS, MM

d	44,000
D	104,800
D1	85,000
D2	85,000
D3	125,000
D4	146,500
B1	76,300

MANUFACTURER

[FAG](#)

