

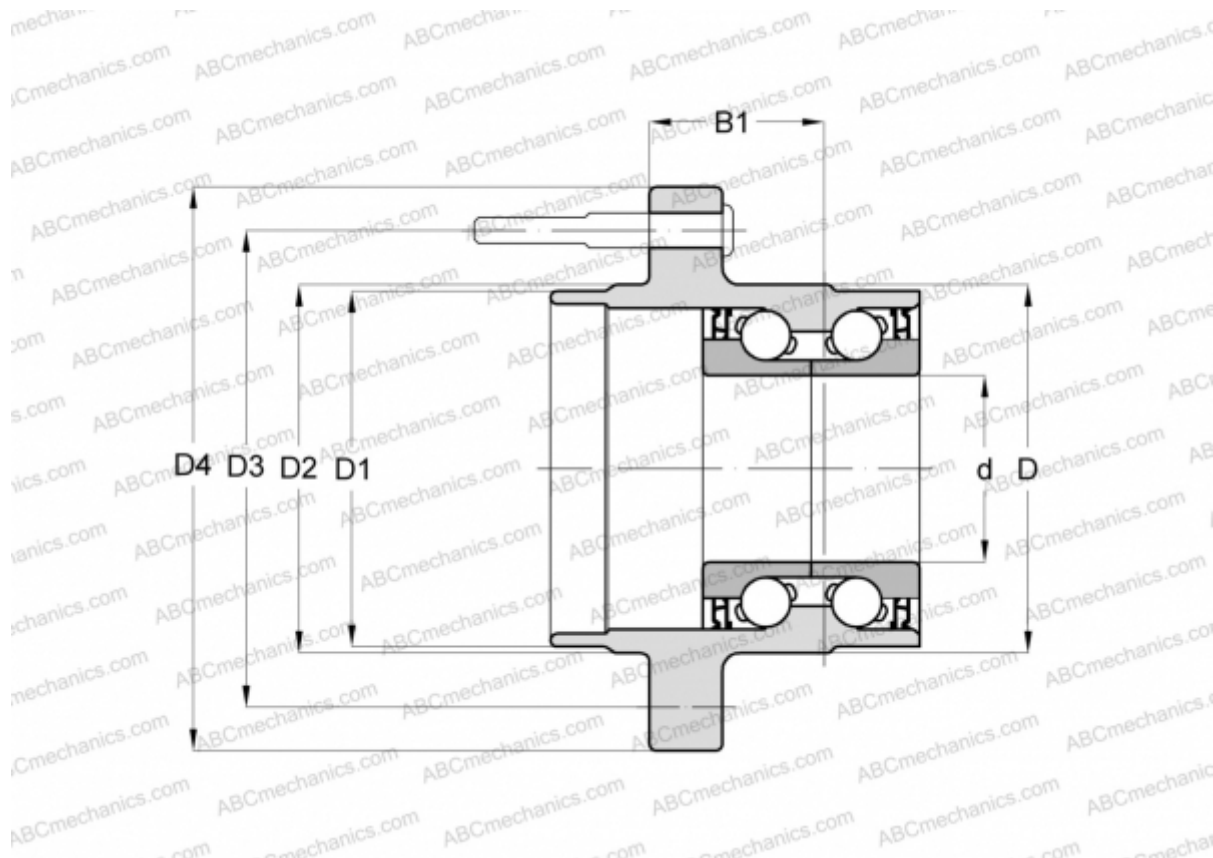

## 102142 FAG

Angular contact ball bearings

TYPE: Ball bearings, Angular contact ball bearing, Double row, Hub bearing (unit), FAG production, generation 2



### Technical specification

#### DIMENSIONS, MM

d	28,000
D	80,000
D1	54,000
D2	65,500
D3	100,000
D4	140,000
B1	50,500

#### MANUFACTURER

[FAG](#)

