

102148 FAG

Angular contact ball bearings

TYPE: Ball bearings, Angular contact ball bearing, Double row, Hub bearing (unit), FAG production, generation 2

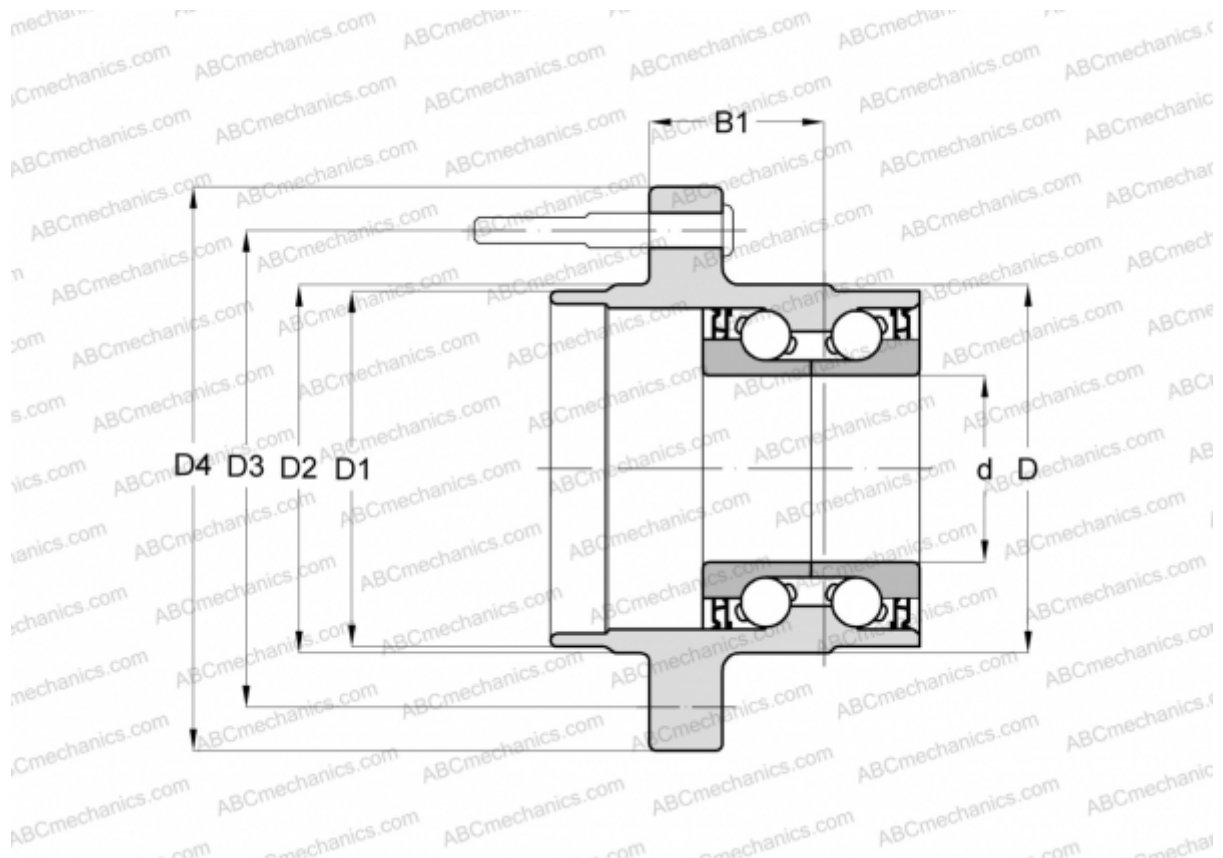

Technical specification

DIMENSIONS, MM

D	62,320
D1	56,900
D2	61,300
D3	100,000
D4	133,710
B1	61,120

MANUFACTURER

[FAG](#)