

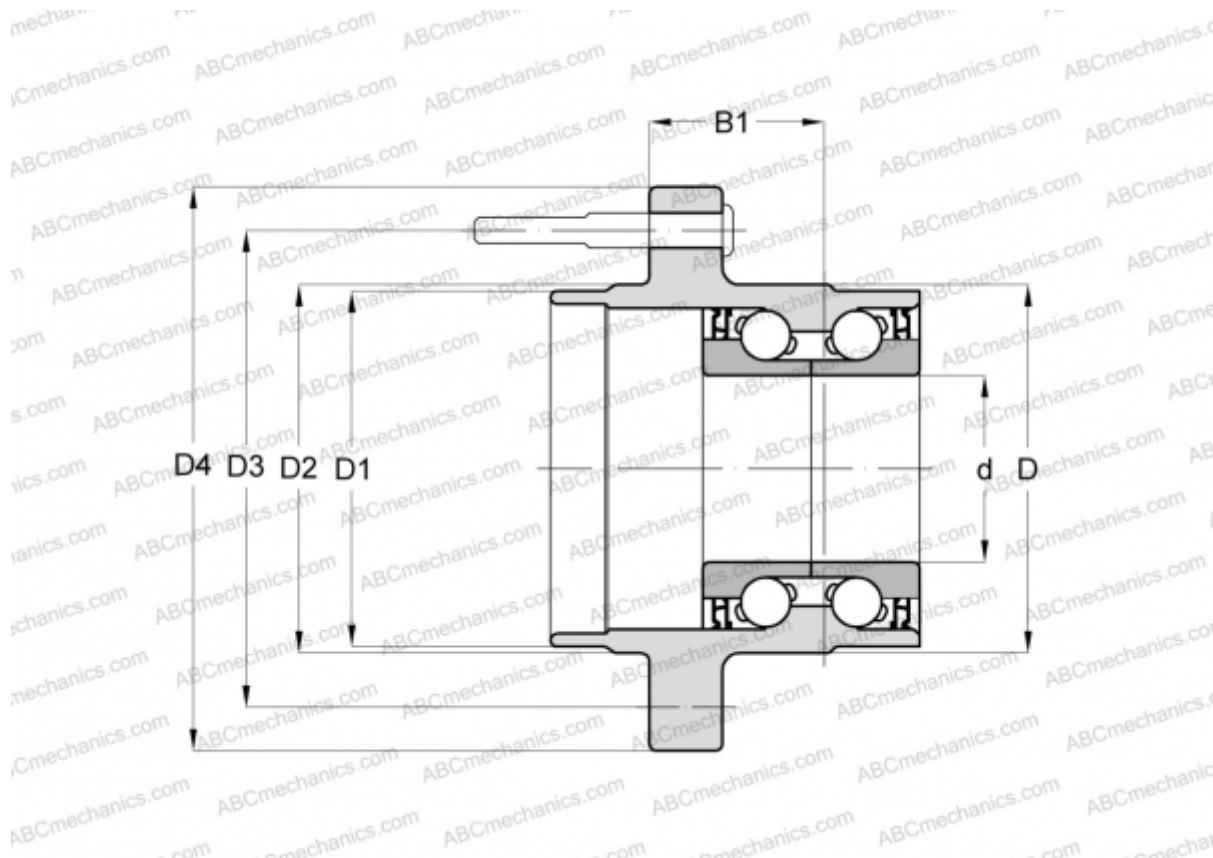

102319 FAG

Angular contact ball bearings

TYPE: Ball bearings, Angular contact ball bearing, Double row, Hub bearing (unit), FAG production, generation 2



Technical specification

DIMENSIONS, MM

d	35,000
D	78,000
D1	67,100
D2	75,900
D3	114,300
D4	148,000
B1	56,100

MANUFACTURER

[FAG](#)

