

## 102328 FAG

Angular contact ball bearings

TYPE: Ball bearings, Angular contact ball bearing, Double row, Hub bearing (unit), FAG production, generation 2

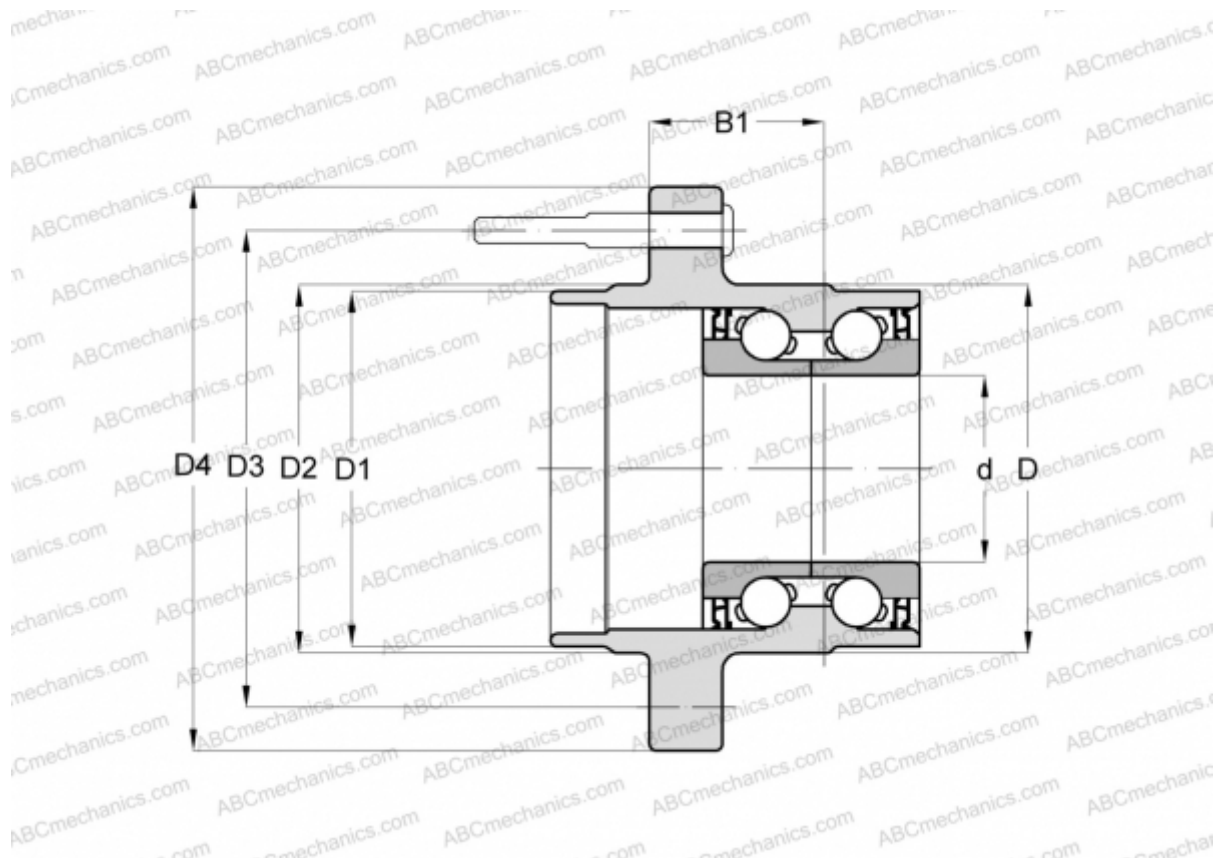

### Technical specification

#### DIMENSIONS, MM

d	28,000
D	80,000
D1	57,700
D2	67,000
D3	114,300
D4	139,000
B1	50,500

#### MANUFACTURER

[FAG](#)