

102351 FAG

Angular contact ball bearings

TYPE: Ball bearings, Angular contact ball bearing, Double row, Hub bearing (unit), FAG production, generation 2

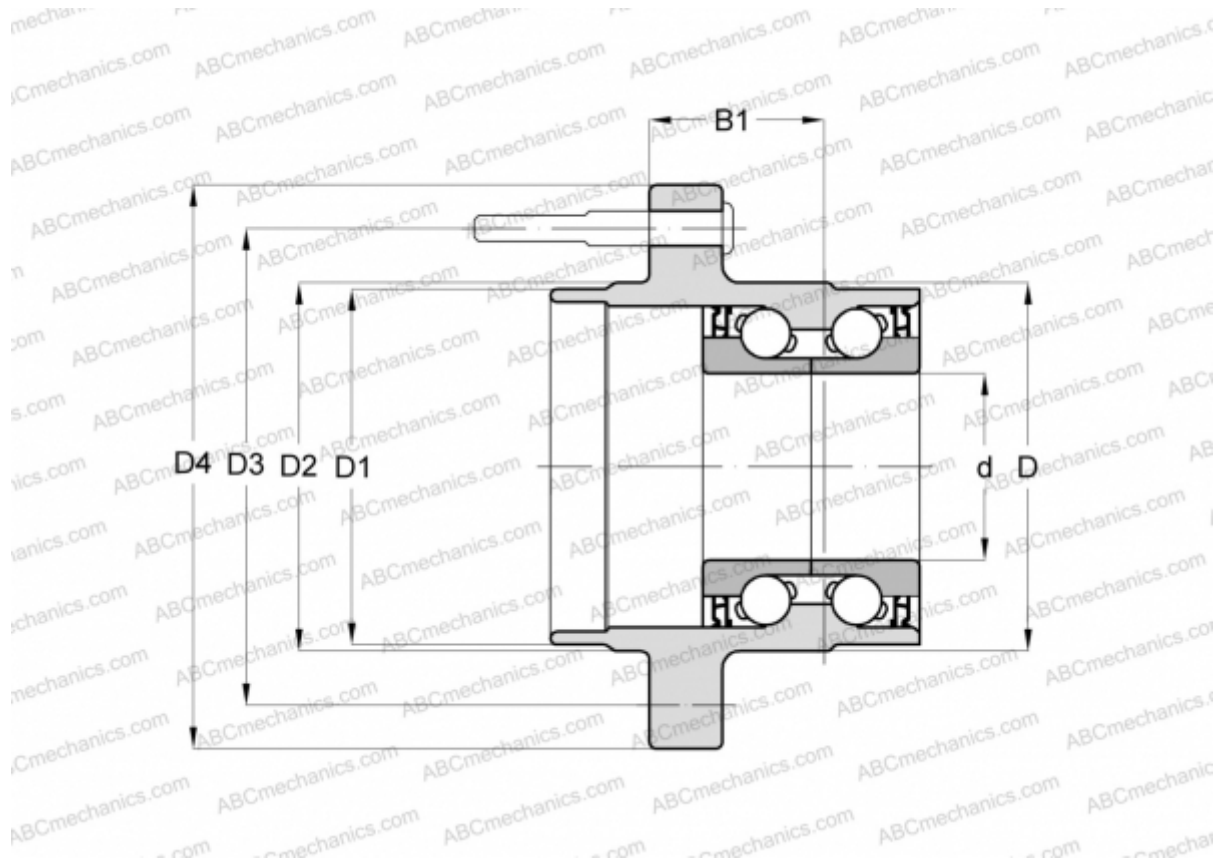

Technical specification

DIMENSIONS, MM

d	58,000
D	106,000
D1	107,300
D2	113,740
B1	53,600
T	141,000

MANUFACTURER

[FAG](#)