

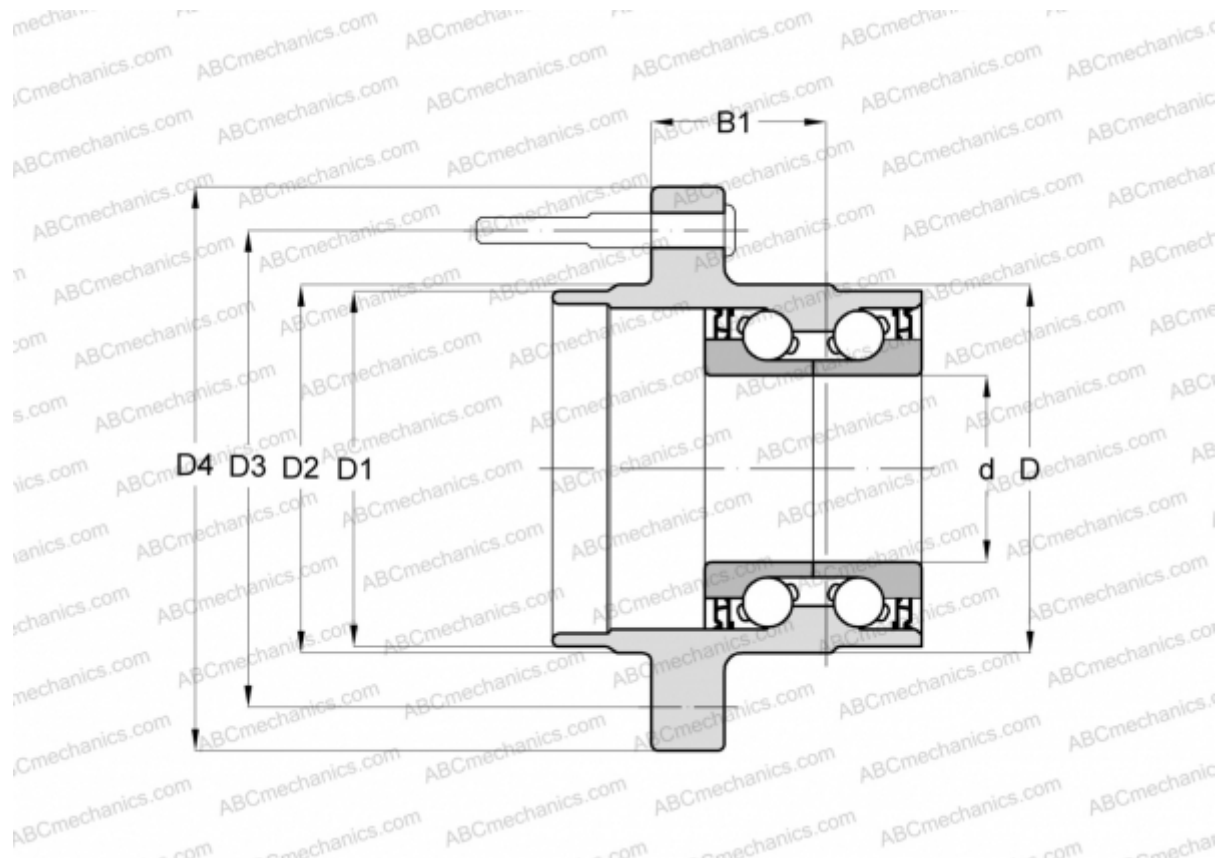

## 102448 FAG

Angular contact ball bearings

TYPE: Ball bearings, Angular contact ball bearing, Double row, Hub bearing (unit), FAG production, generation 2



### Technical specification

#### DIMENSIONS, MM

d	36,000
D	90,000
D1	67,000
D2	72,000
D3	114,300
D4	139,500
B1	61,000

#### MANUFACTURER

[FAG](#)

