

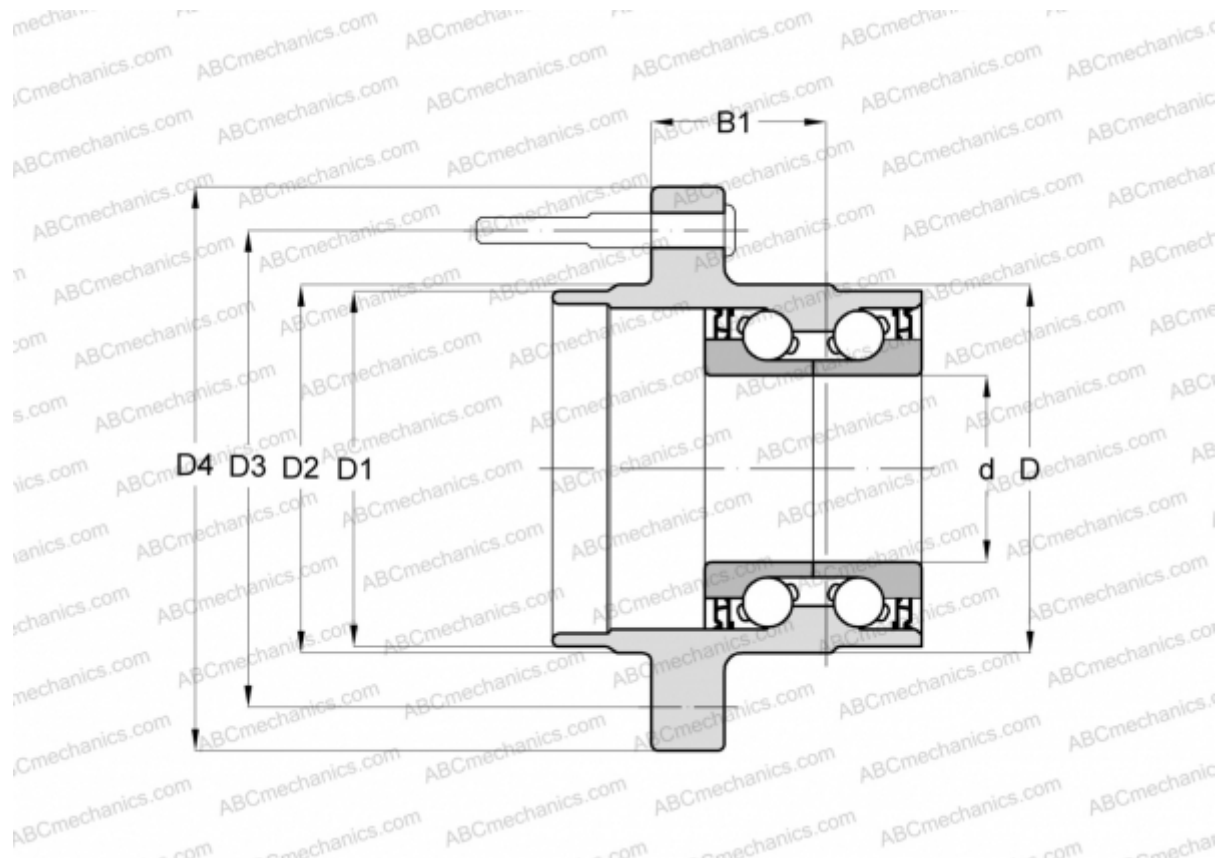

102485 FAG

Angular contact ball bearings

TYPE: Ball bearings, Angular contact ball bearing, Double row, Hub bearing (unit), FAG production, generation 2



Technical specification

DIMENSIONS, MM

d	30,000
D	68,200
D1	68,200
D2	68,200
D3	99,000
B1	52,000

MANUFACTURER

[FAG](#)

