

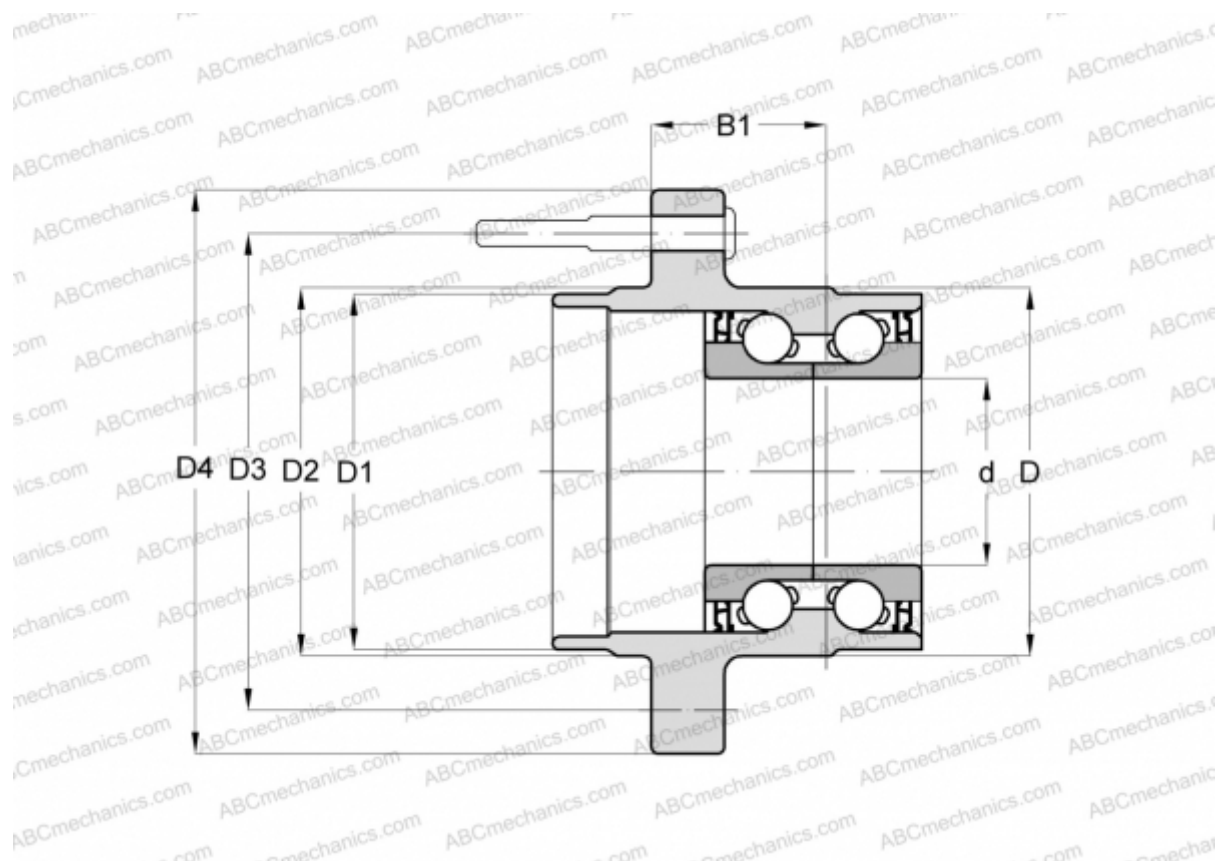

102495 FAG

Angular contact ball bearings

TYPE: Ball bearings, Angular contact ball bearing, Double row, Hub bearing (unit), FAG production, generation 2



Technical specification

DIMENSIONS, MM

D	63,652
D1	56,032
D2	64,008
D3	99,085
D4	125,552

MANUFACTURER

[FAG](#)

