

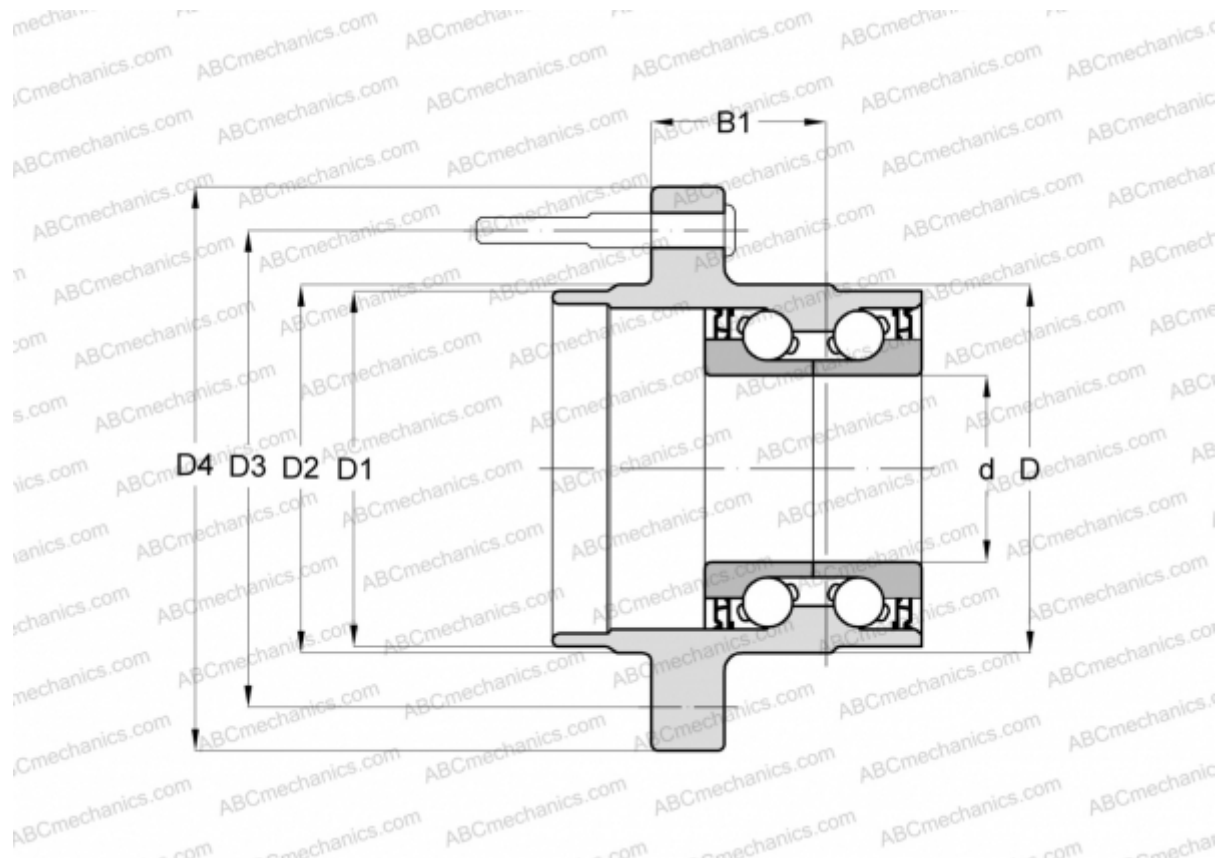

## 102602 FAG

Angular contact ball bearings

TYPE: Ball bearings, Angular contact ball bearing, Double row, Hub bearing (unit), FAG production, generation 2



### Technical specification

#### DIMENSIONS, MM

|    |         |
|----|---------|
| d  | 51,000  |
| D  | 86,200  |
| D1 | 86,800  |
| D2 | 87,000  |
| D3 | 112,000 |
| B1 | 55,000  |

#### MANUFACTURER

[FAG](#)

