

102752 FAG

Angular contact ball bearings

TYPE: Ball bearings, Angular contact ball bearing, Double row, Hub bearing (unit), FAG production, generation 2

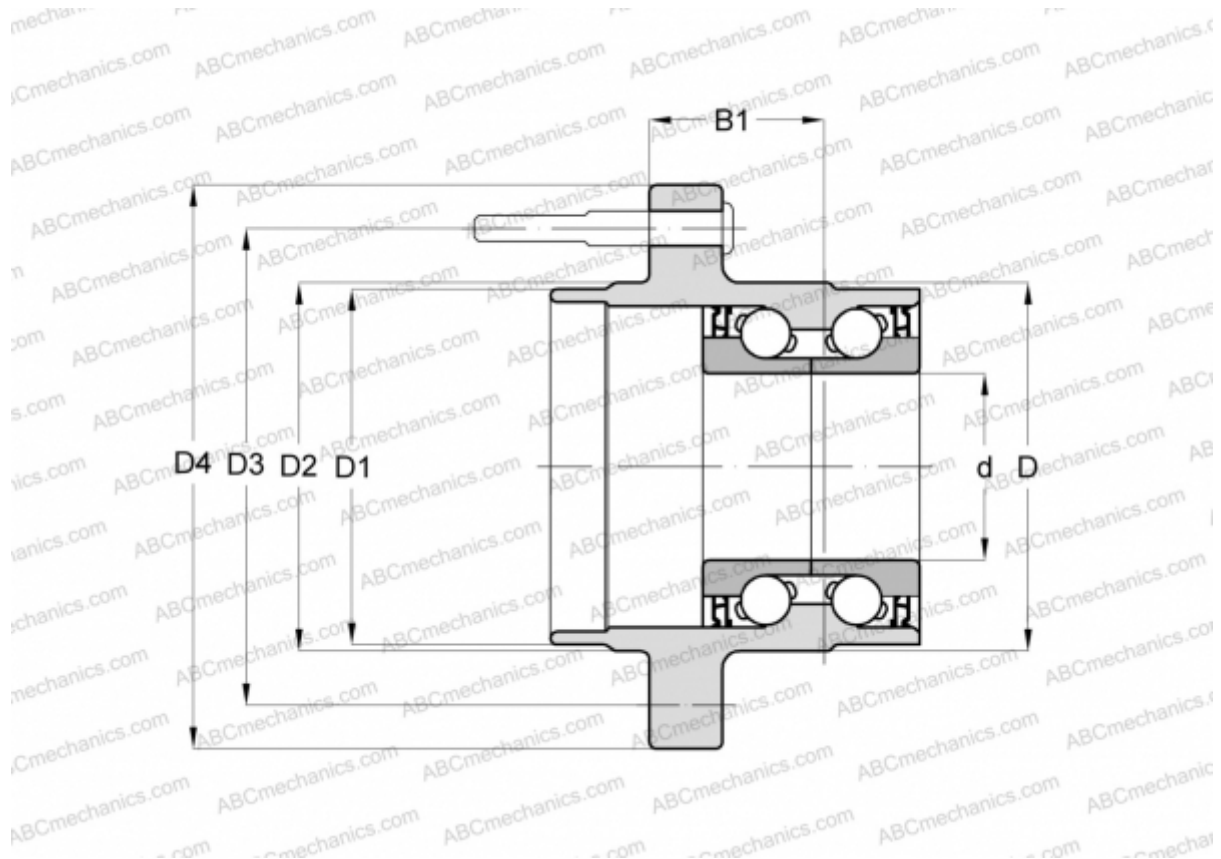

Technical specification

DIMENSIONS, MM

d	50,000
D	94,500
D1	86,500
D2	86,500
B1	63,000
T	114,300

MANUFACTURER

[FAG](#)