

806082 FAG

Angular contact ball bearings

TYPE: Ball bearings, Angular contact ball bearing, Double row, Hub bearing (unit), FAG production, generation 2

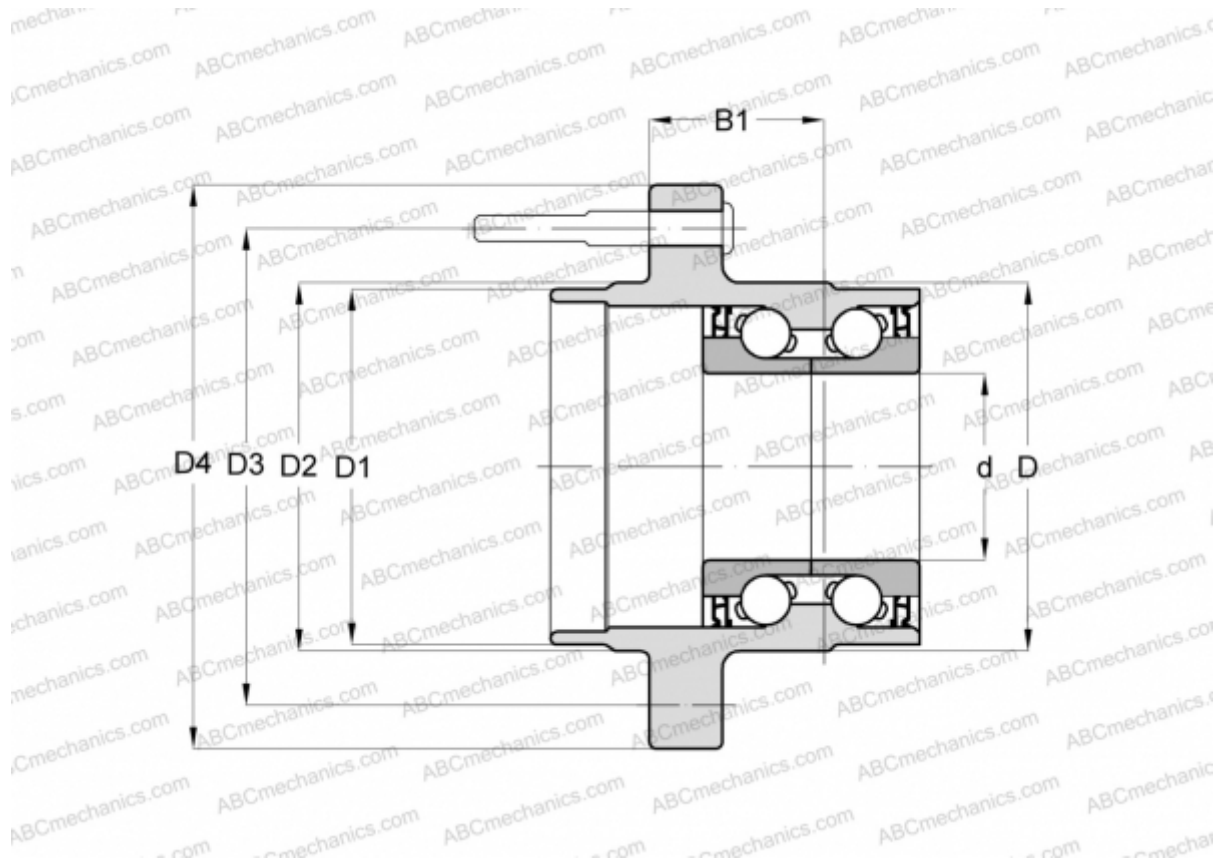

Technical specification

DIMENSIONS, MM

d	35,000
D	89,200
D1	92,300
D2	96,300
D3	139,700
D4	161,200
B1	53,000

MANUFACTURER

[FAG](#)