

E30-KLL INA

Insert bearings

TYPE: Ball bearings, Radial insert bearings, With eccentric locking collar, Cylindrical outer ring, Series E..-KLL(INA), seals on both side

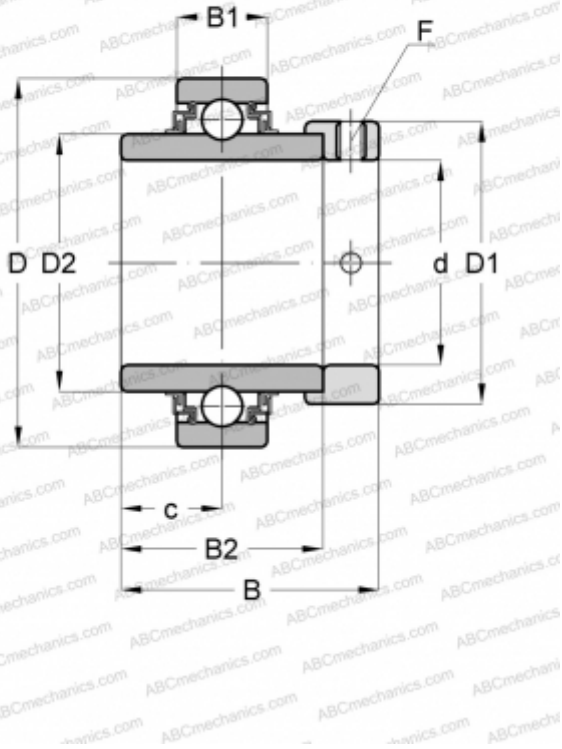

Technical specification

DIMENSIONS, MM

d	30,000
D	62,000
D1	44,000
D2	40,200
B	48,500
B1	18,000
B2	36,500
c	18,300
F	4

WEIGHT, KG

0,390

MANUFACTURER

[INA](#)

REPLACES

E30-XL-KLL