

RABRB15/47-FA106 INA

Insert bearings

TYPE: Ball bearings, Radial insert bearings, Rubber interliner, Eccentric locking collar, series RABRA, RABRB(INA), seals on both side

Technical specification

DIMENSIONS, MM

d	15,000
D	47,300
D1	28,000
D2	33,500
B	31,100
B1	18,000
B2	28,600
c	22,100

WEIGHT, KG

0,150

MANUFACTURER

[INA](#)

REPLACES

RABRB15/47-XL-FA106

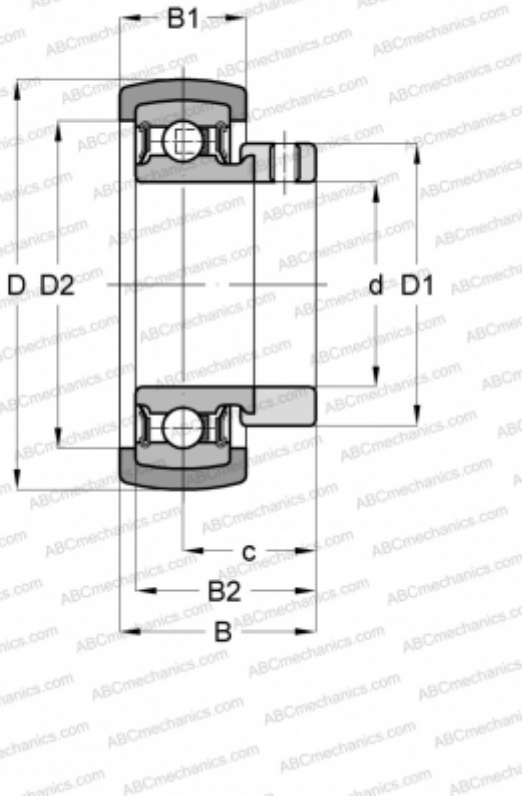

ASSOCIATED PRODUCTS

RAE15-NPP-B-FA106