

RABRB30/72-FA106 INA

Insert bearings

TYPE: Ball bearings, Radial insert bearings, Rubber interliner, Eccentric locking collar, series RABRA, RABRB(INA), seals on both side

Technical specification

DIMENSIONS, MM

d	30,000
D	72,200
D1	44,000
D2	54,000
B	38,200
B1	23,000
B2	35,800
c	26,700

WEIGHT, KG

0,380

MANUFACTURER

[INA](#)

REPLACES

RABRB30/72-XL-FA106

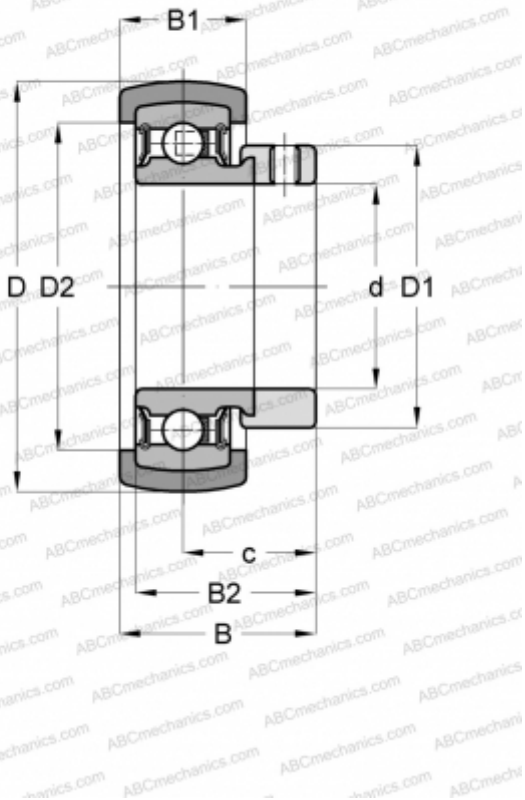

ASSOCIATED PRODUCTS

RAE30-NPP-B-FA106