

BE20 INA

Insert bearings

TYPE: Ball bearings, Radial insert bearings, With steel aligning ring, Cylindrical outer ring, series BE(INA), seals on both side

Technical specification

DIMENSIONS, MM

d	20,000
D	55,000
D2	52,600
B	16,000
B1	14,000
T	1,350
T1	11,200
E	204

WEIGHT, KG

0,190

MANUFACTURER

[INA](#)

REPLACES

BE20-XL

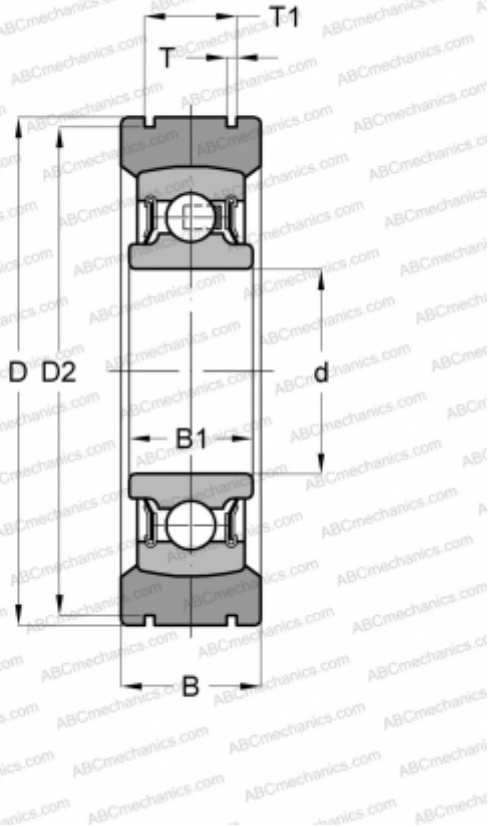

ASSOCIATED PRODUCTS

204-NPP-B