

BE40 INA

Insert bearings

TYPE: Ball bearings, Radial insert bearings, With steel aligning ring, Cylindrical outer ring, series BE(INA), seals on both side

Technical specification

DIMENSIONS, MM

d	40,000
D	90,000
D2	86,800
B	25,000
B1	18,000
T	2,700
T1	15,400
E	208

WEIGHT, KG

0,630

MANUFACTURER

[INA](#)

REPLACES

BE40-XL

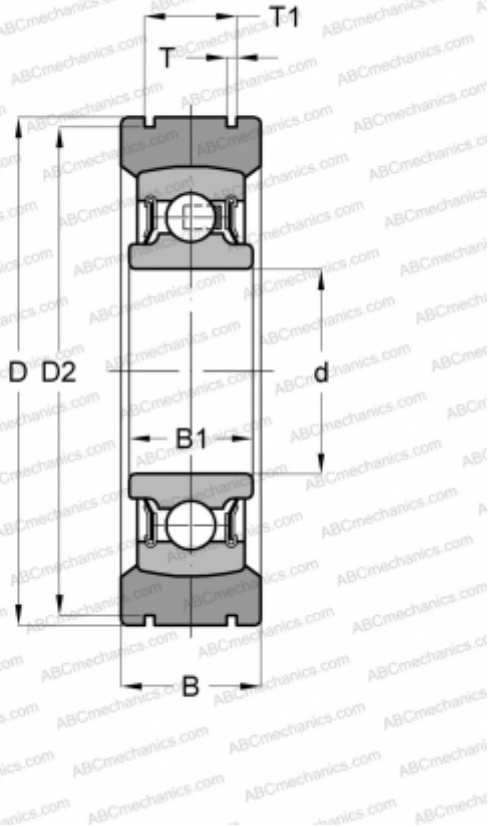

ASSOCIATED PRODUCTS

208-NPP-B