

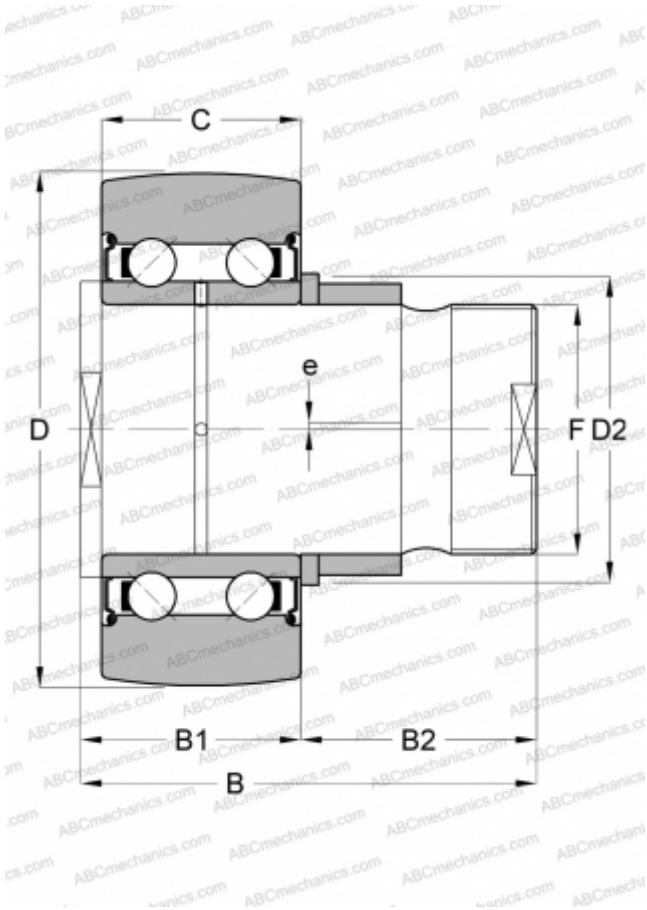

ZLE5201-2Z INA

Stud type track rollers

TYPE: Ball bearings, Stud type track rollers, Double row, Eccentric stud, gap seals on both sides



Technical specification

| DIMENSIONS, MM | |
|---------------------|--------|
| d | 18,000 |
| D | 35,000 |
| D2 | 25,000 |
| B | 65,500 |
| B1 | 20,500 |
| B2 | 45,000 |
| C | 15,900 |
| F | M6 |
| WEIGHT, KG | |
| 0,250 | |
| MANUFACTURER | |
| INA | |

