

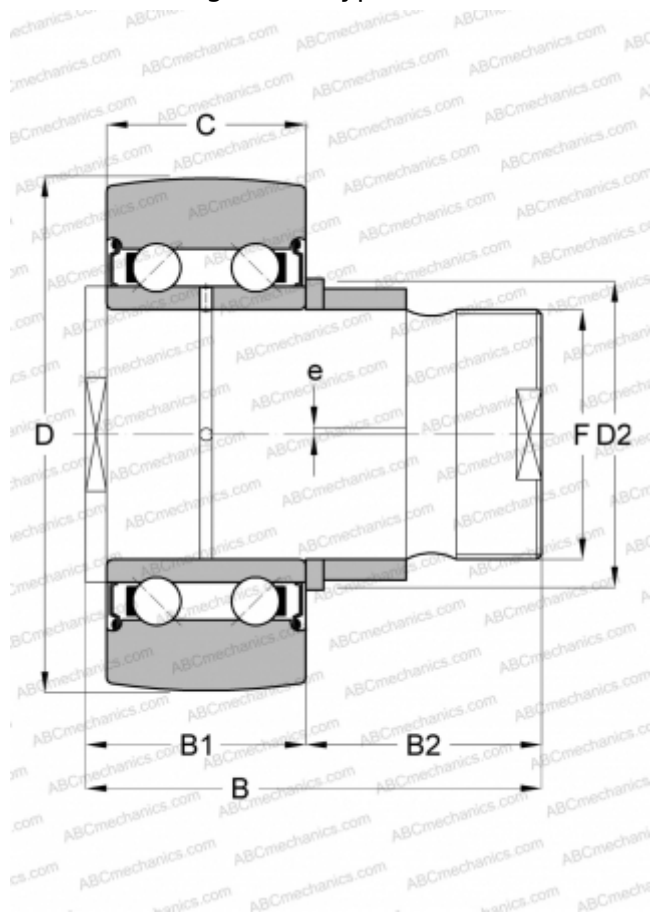

ZLE5202-2Z INA

Stud type track rollers

TYPE: Ball bearings, Stud type track rollers, Double row, Eccentric stud, gap seals on both sides



Technical specification

DIMENSIONS, MM

d	22,000
D	40,000
D2	27,000
B	66,500
B1	21,500
B2	45,000
C	15,900
F	M14

WEIGHT, KG

0,350

MANUFACTURER

[INA](https://www.ina.com)

