

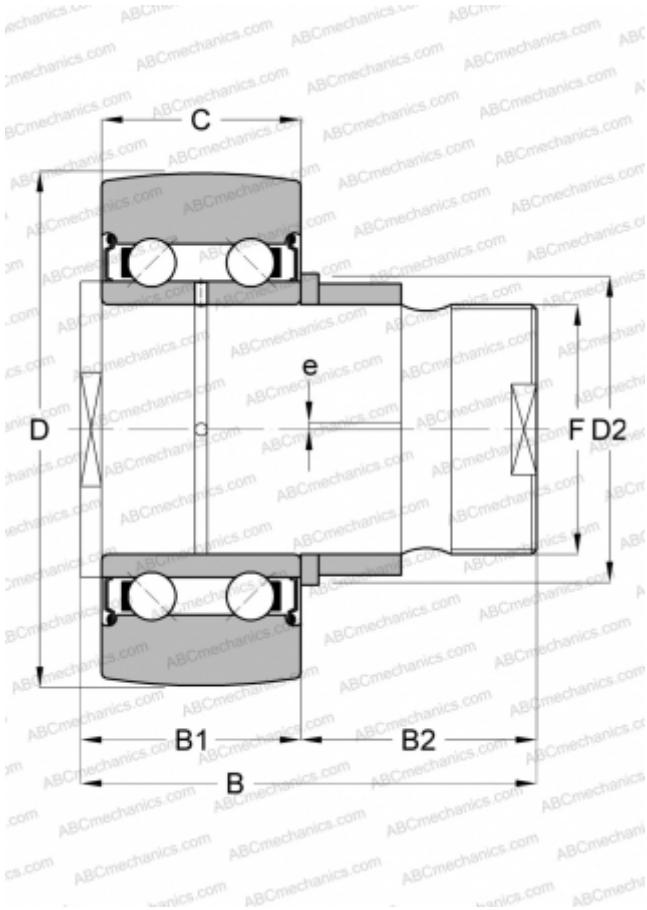

ZLE5207-2Z INA

Stud type track rollers

TYPE: Ball bearings, Stud type track rollers, Double row, Eccentric stud, gap seals on both sides



Technical specification

| DIMENSIONS, MM |                     |
|----------------|---------------------|
| d              | 35,000              |
| D              | 80,000              |
| D2             | 45,000              |
| B              | 99,000              |
| B1             | 35,000              |
| B2             | 64,000              |
| C              | 27,000              |
| F              | M30X1,5             |
| WEIGHT, KG     |                     |
|                | 1,300               |
| MANUFACTURER   |                     |
|                | <a href="#">INA</a> |

