

CFE 14 PP INA

Cam followers

TYPE: Roller bearings, Stud type track rollers, Eccentric stud, hex socket, contact seals on both side, cylindrical outer ring, inch size

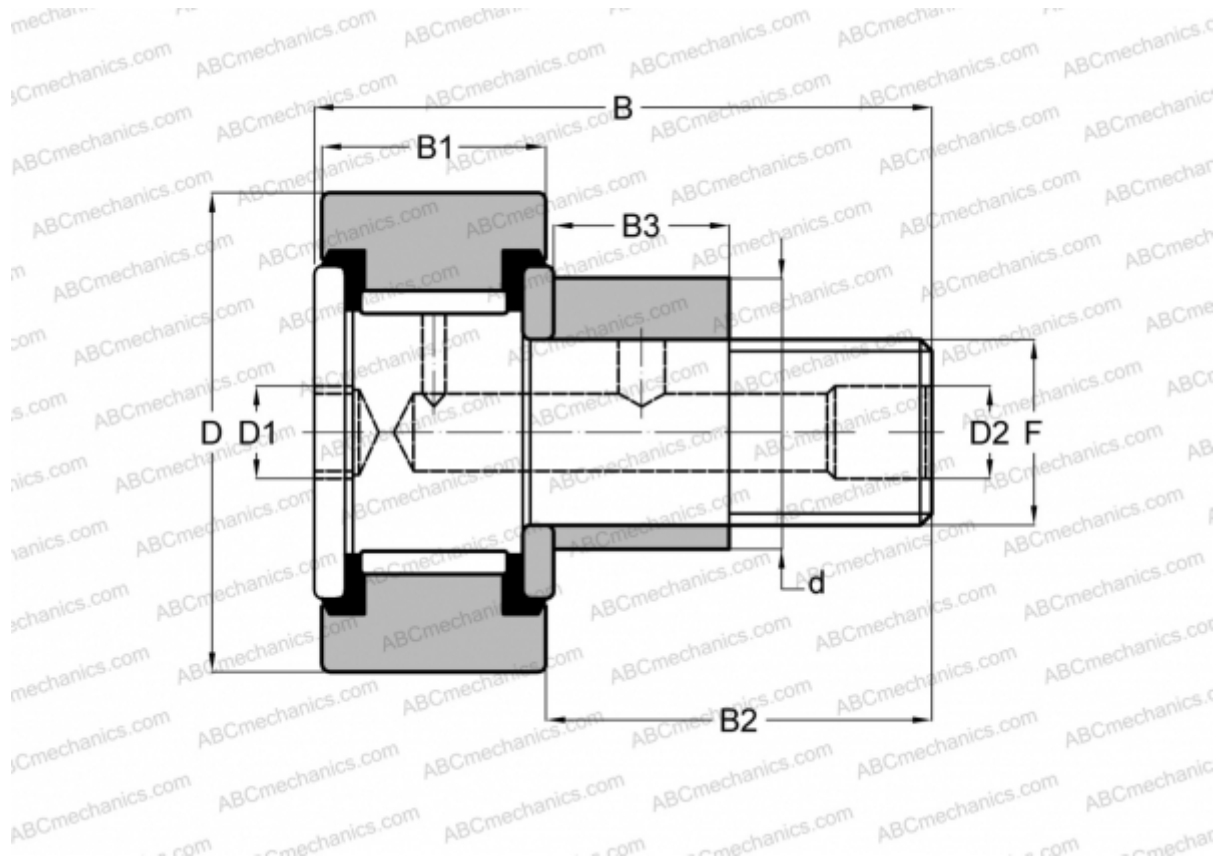

Technical specification

DIMENSIONS, MM

d	12,700
D	22,225
D1	4,763
D2	4,763
B	35,718
B1	12,700
B2	22,225
B3	12,700
F	3/8 - 24

WEIGHT, KG 0,050

MANUFACTURER [INA](#)

INTERCHANGE

TORRINGTON [CRSBE 14](#)

INTERCHANGE

McGill [CFE 7/8 SB](#)

RBC [S 28 LWX](#)

SMITH BEARING [CR 7/8 XBE](#)