

CFE 1 SB McGill

Cam followers

TYPE: Roller bearings, Stud type track rollers, Eccentric stud, hex socket, contact seals on both side, cylindrical outer ring, inch size

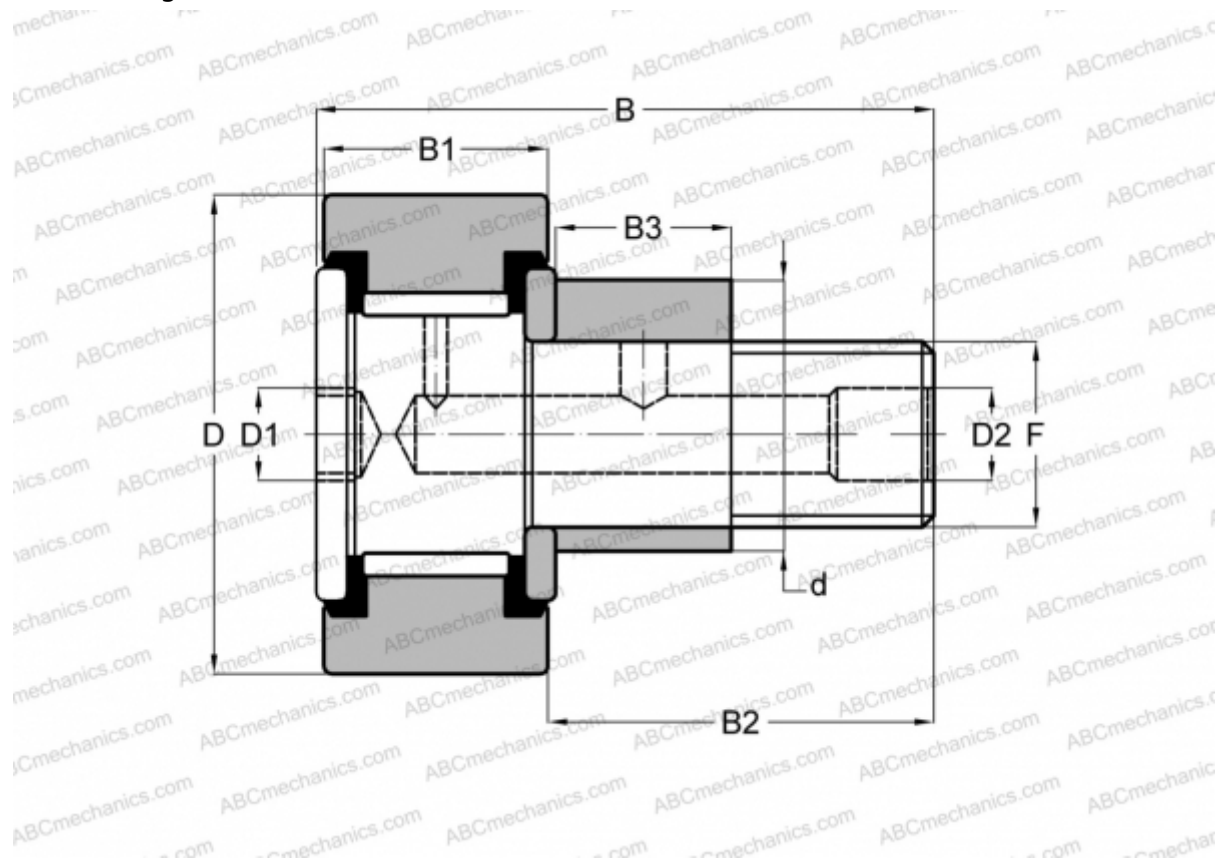

Technical specification

DIMENSIONS, MM

d	15,875
D	25,400
D1	6,350
D2	4,763
B	42,068
B1	15,875
B2	25,400
B3	12,700
F	7/16-20

WEIGHT, KG 0,082

MANUFACTURER [McGill](#)

INTERCHANGE

TORRINGTON [CRSBE 16](#)

INTERCHANGE

INA [CFE 16 PP](#)

RBC [S 32 LWX](#)

SMITH BEARING [CR 1 XBE](#)