

CFE 1 1/8 SB McGill

Cam followers

TYPE: Roller bearings, Stud type track rollers, Eccentric stud, hex socket, contact seals on both side, cylindrical outer ring, inch size

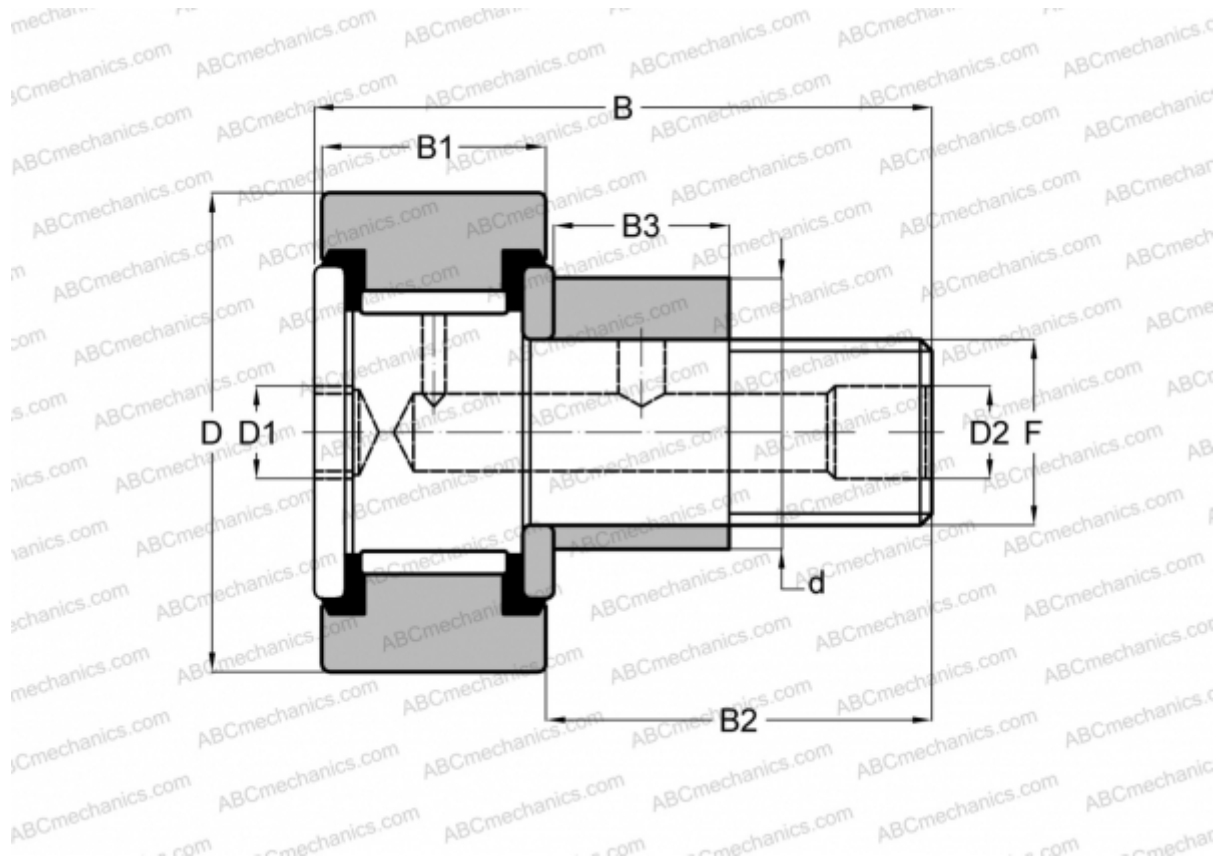

Technical specification

DIMENSIONS, MM

d	15,875
D	28,575
D1	6,350
D2	4,763
B	42,068
B1	15,875
B2	25,400
B3	12,700
F	7/16-20

WEIGHT, KG 0,095

MANUFACTURER [McGill](#)

INTERCHANGE

TORRINGTON [CRSBE 18](#)

INTERCHANGE

INA [CFE 18 PP](#)

RBC [S 36 LWX](#)

SMITH BEARING [CR 1 1/8 XBE](#)