

CFE 1 3/8 SB McGill

Cam followers

TYPE: Roller bearings, Stud type track rollers, Eccentric stud, hex socket, contact seals on both side, cylindrical outer ring, inch size

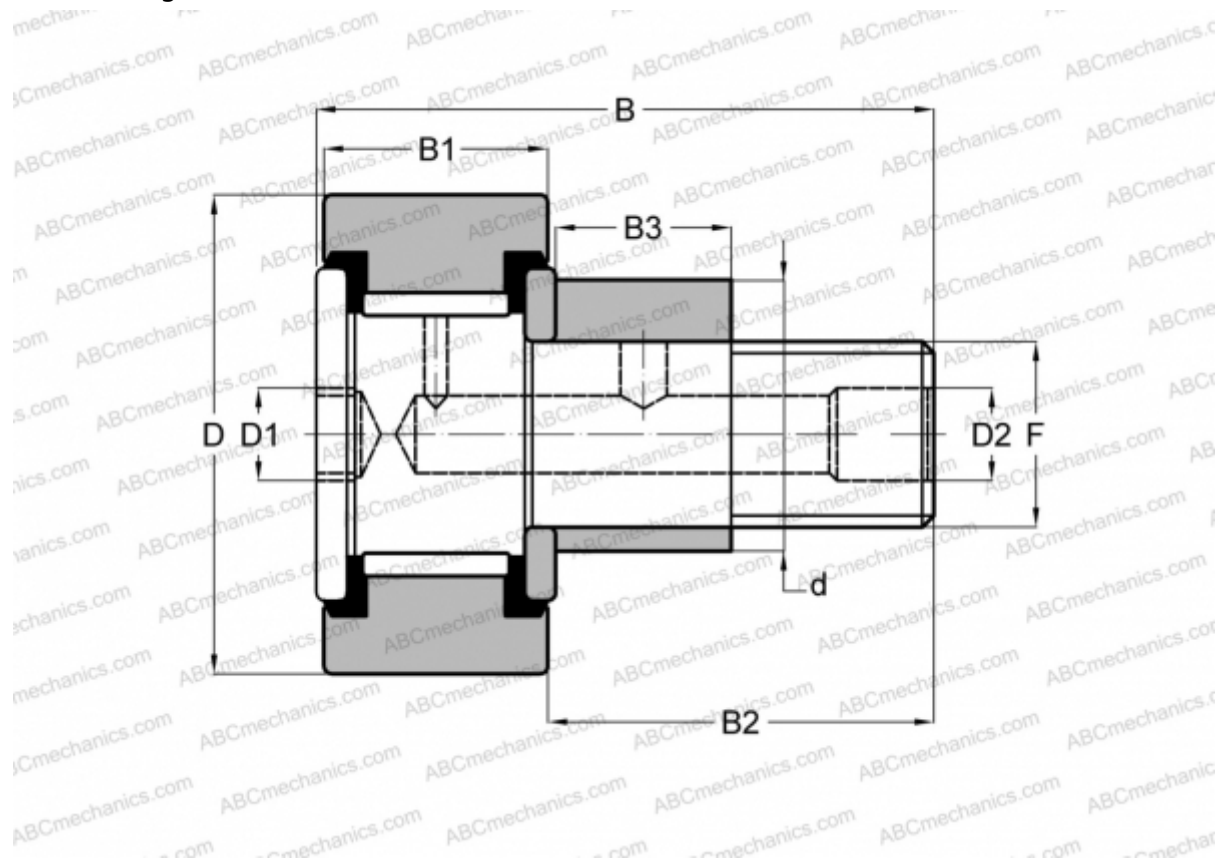

Technical specification

DIMENSIONS, MM

| | |
|----|---------|
| d | 17,463 |
| D | 34,925 |
| D1 | 6,350 |
| D2 | 4,763 |
| B | 51,593 |
| B1 | 19,050 |
| B2 | 31,750 |
| B3 | 15,875 |
| F | 1/2 -20 |

WEIGHT, KG 0,172

MANUFACTURER [McGill](#)

INTERCHANGE

TORRINGTON [CRSBE 22](#)

INTERCHANGE

INA [CFE 22 PP](#)

RBC [S 44 LWX](#)

SMITH BEARING [CR 1 3/8 XBE](#)