

## CRSBE 24 TORRINGTON

Cam followers

TYPE: Roller bearings, Stud type track rollers, Eccentric stud, hex socket, contact seals on both side, cylindrical outer ring, inch size

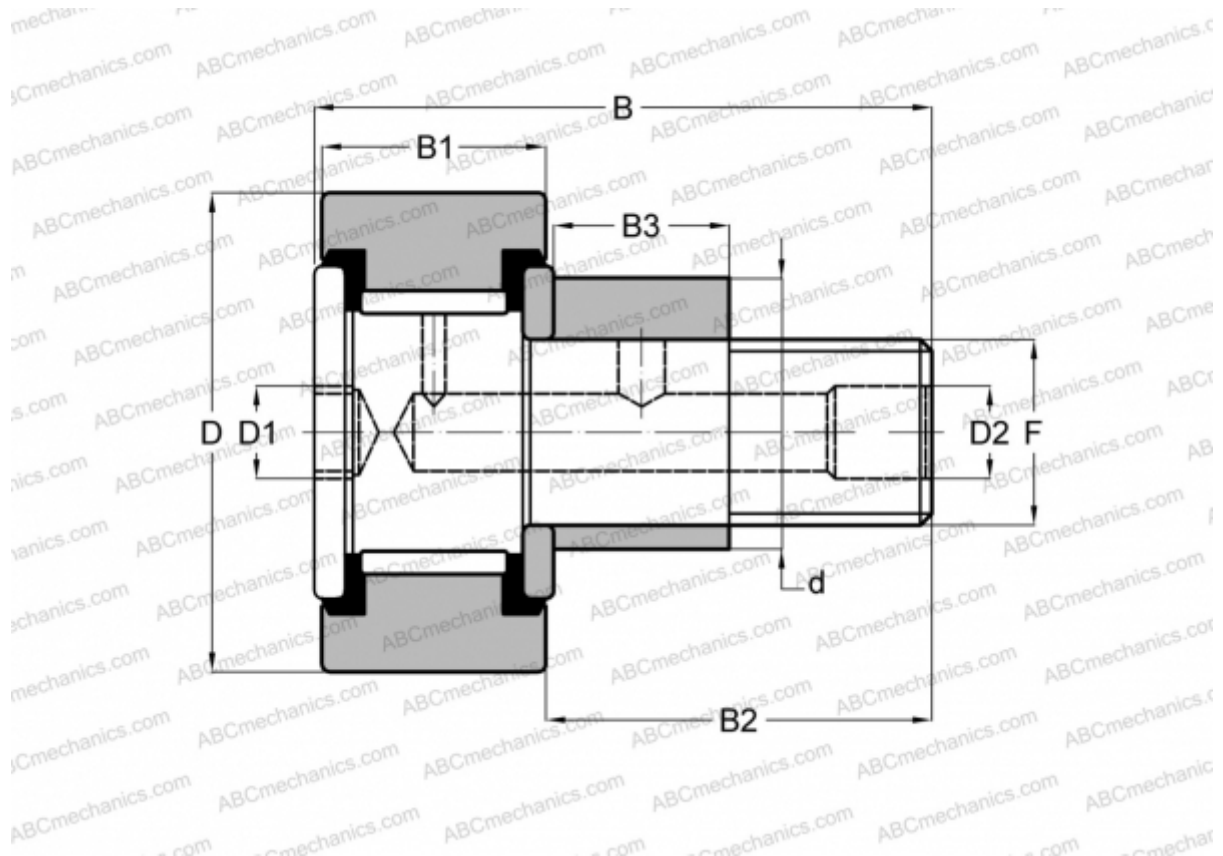

### Technical specification

#### DIMENSIONS, MM

d	22,225
D	38,100
D1	7,938
D2	4,763
B	61,118
B1	22,225
B2	38,100
B3	19,050
F	5/8-18

#### INTERCHANGE

McGill	<a href="#">CFE 1 1/2 SB</a>
RBC	<a href="#">S 48 LWX</a>
SMITH BEARING	<a href="#">CR 1 1/2 XBE</a>

**WEIGHT, KG** 0,263

**MANUFACTURER** [TORRINGTON](#)

#### INTERCHANGE

INA	<a href="#">CFE 24 PP</a>
-----	---------------------------