

## CR 1 5/8 XBE SMITH BEARING

Cam followers

TYPE: Roller bearings, Stud type track rollers, Eccentric stud, hex socket, contact seals on both side, cylindrical outer ring, inch size

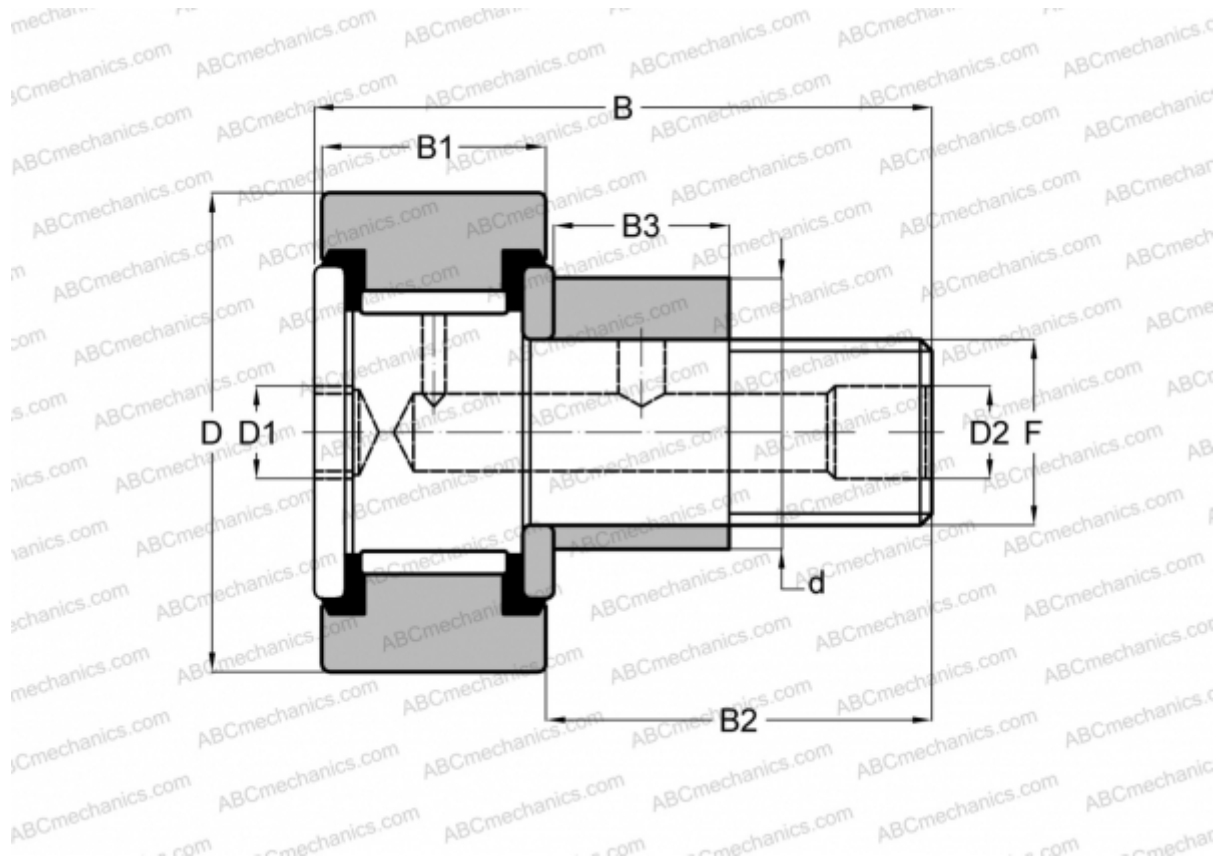

### Technical specification

#### DIMENSIONS, MM

|    |        |
|----|--------|
| d  | 22,225 |
| D  | 41,275 |
| D1 | 7,938  |
| D2 | 4,763  |
| B  | 61,118 |
| B1 | 22,225 |
| B2 | 38,100 |
| B3 | 19,050 |
| F  | 5/8-18 |

#### INTERCHANGE

|        |                              |
|--------|------------------------------|
| INA    | <a href="#">CFE 26 PP</a>    |
| McGill | <a href="#">CFE 1 5/8 SB</a> |
| RBC    | <a href="#">S 52 LWX</a>     |

**WEIGHT, KG** 0,295

**MANUFACTURER** [SMITH BEARING](#)

**INTERCHANGE** [TORRINGTON CRSBE 26](#)