

## CRSBE 28 TORRINGTON

Cam followers

TYPE: Roller bearings, Stud type track rollers, Eccentric stud, hex socket, contact seals on both side, cylindrical outer ring, inch size

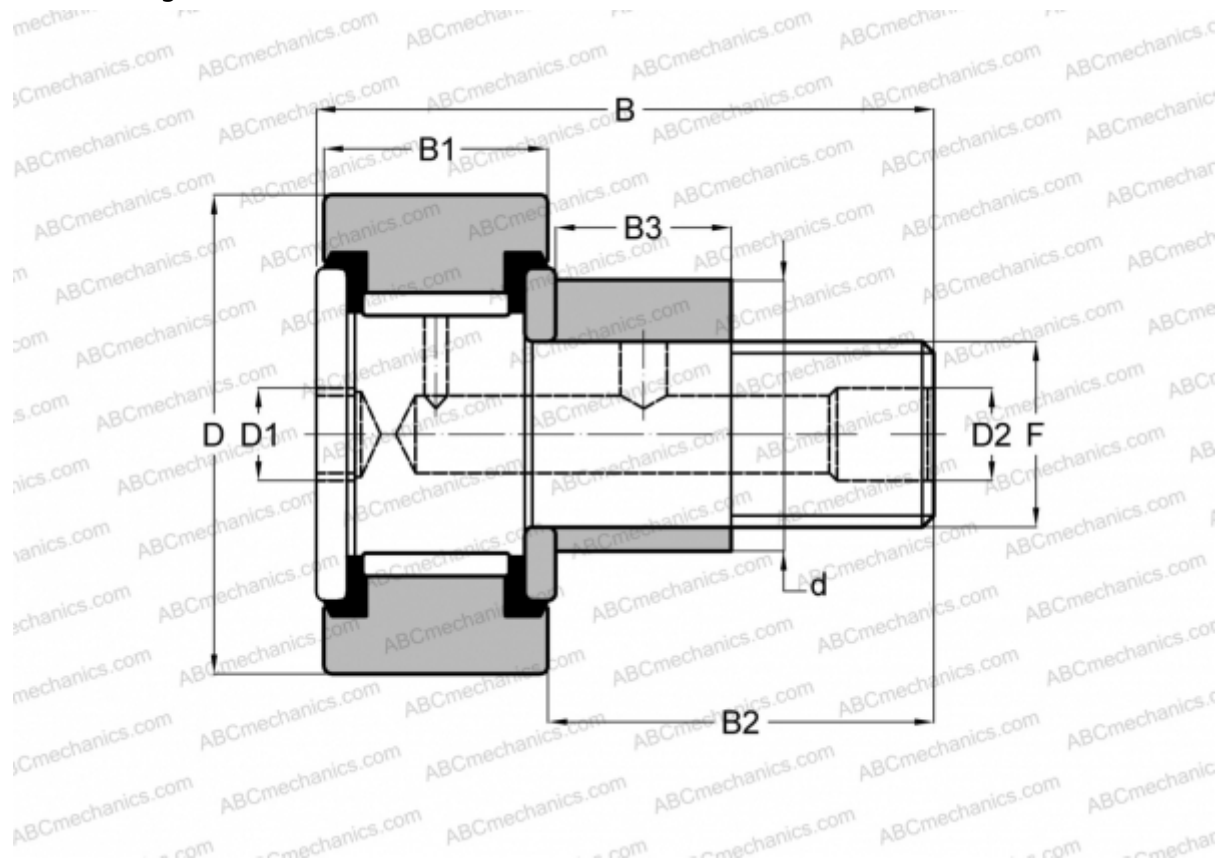

### Technical specification

#### DIMENSIONS, MM

d	25,400
D	44,450
D1	7,938
D2	4,763
B	70,643
B1	25,400
B2	44,450
B3	22,225
F	3/4-16

**WEIGHT, KG** 0,408

**MANUFACTURER** [TORRINGTON](#)

#### INTERCHANGE

INA [CFE 28 PP](#)

#### INTERCHANGE

McGill [CFE 1 3/4 SB](#)

RBC [S 56 LWX](#)

SMITH BEARING [CR 1 3/4 XBE](#)