

## CFE 2 1/2 SB McGill

Cam followers

TYPE: Roller bearings, Stud type track rollers, Eccentric stud, hex socket, contact seals on both side, cylindrical outer ring, inch size

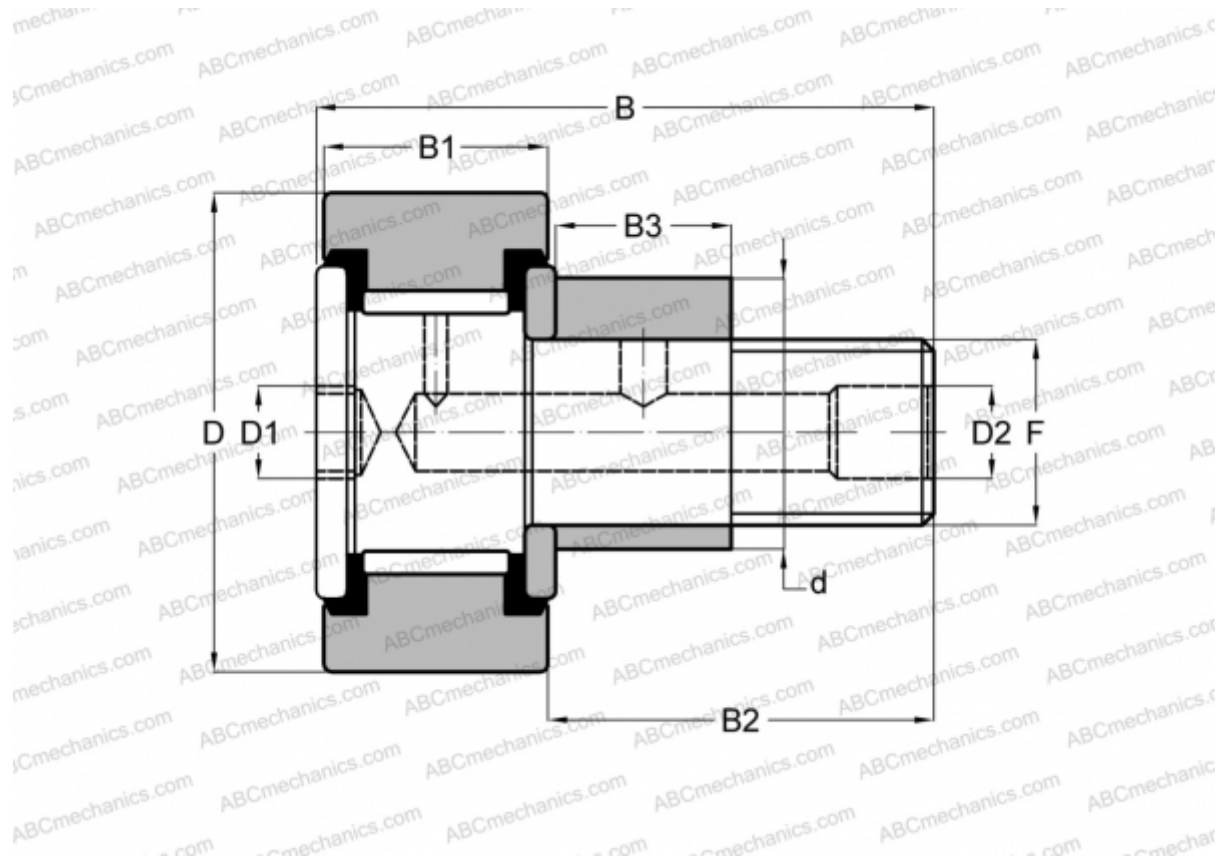

### Technical specification

#### DIMENSIONS, MM

d	34,925
D	63,500
D1	12,700
D2	4,763
B	96,043
B1	38,100
B2	57,150
B3	28,575
F	1-14

**WEIGHT, KG** 1,179

**MANUFACTURER** [McGill](#)

#### INTERCHANGE

TORRINGTON [CRSBE 40](#)

#### INTERCHANGE

INA [CFE 40 PP](#)

RBC [S 80 LWX](#)

SMITH BEARING [CR 2 1/2 XBE](#)