

CRSBE 44 TORRINGTON

Cam followers

TYPE: Roller bearings, Stud type track rollers, Eccentric stud, hex socket, contact seals on both side, cylindrical outer ring, inch size

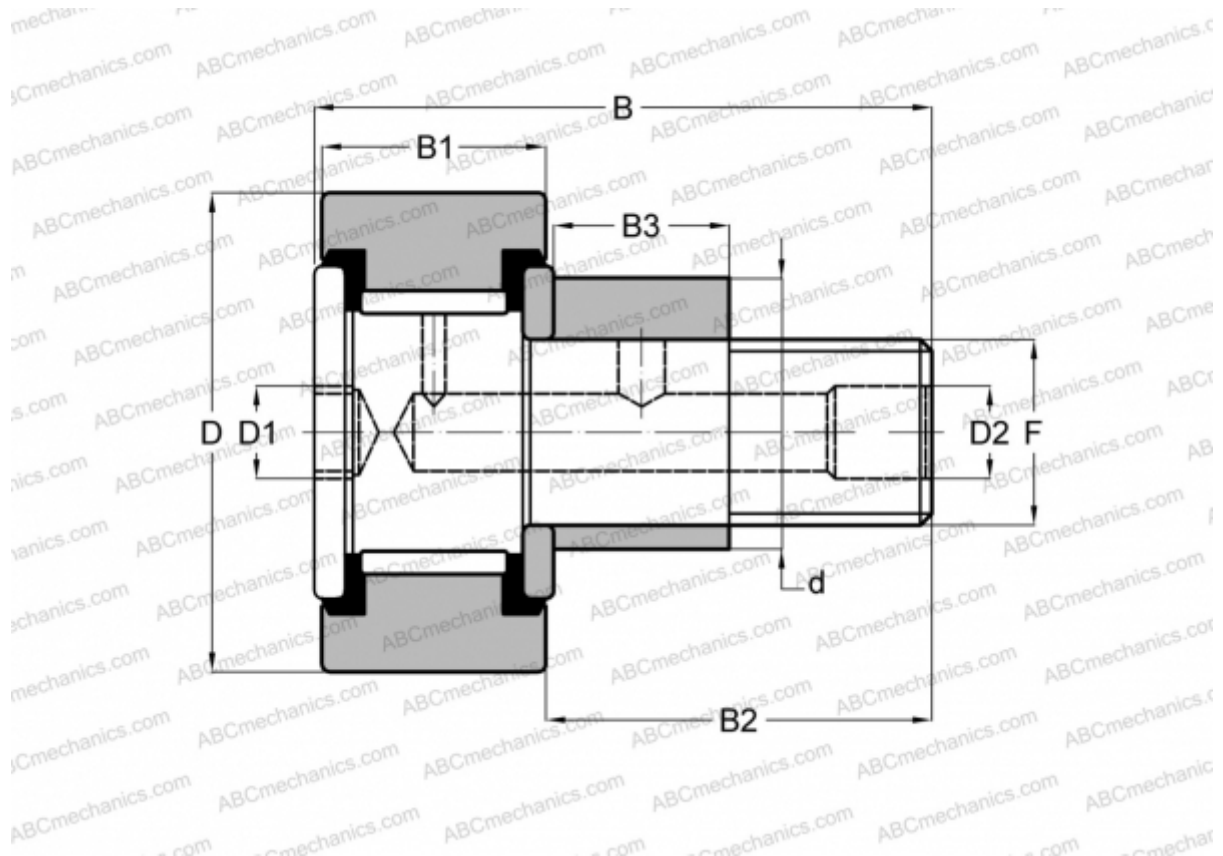

Technical specification

DIMENSIONS, MM

d	34,925
D	69,850
D1	12,700
D2	4,763
B	96,043
B1	38,100
B2	57,150
B3	28,575
F	1-14

INTERCHANGE

McGill	CFE 2 3/4 SB
RBC	S 88 LWX
SMITH BEARING	CR 2 3/4 XBE

WEIGHT, KG 1,374

MANUFACTURER [TORRINGTON](#)

INTERCHANGE

INA [CFE 44 PP](#)