

CRSBE 48 TORRINGTON

Cam followers

TYPE: Roller bearings, Stud type track rollers, Eccentric stud, hex socket, contact seals on both side, cylindrical outer ring, inch size

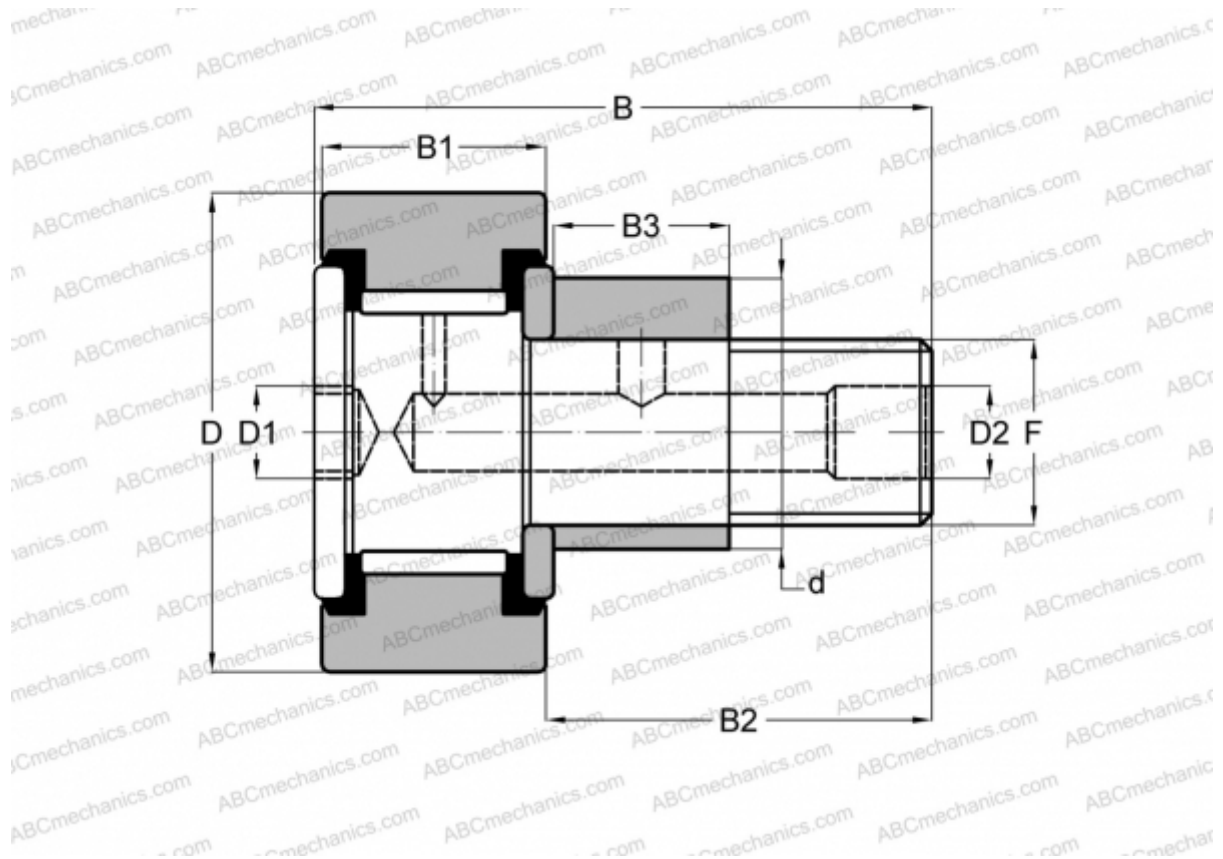

Technical specification

DIMENSIONS, MM

d	44,450
D	76,200
D1	15,875
D2	6,350
B	108,742
B1	44,450
B2	63,500
B3	31,750
F	1 1/4-12

WEIGHT, KG 2,000

MANUFACTURER [TORRINGTON](#)

INTERCHANGE

INA [CFE 48 PP](#)

INTERCHANGE

McGill [CFE 3 SB](#)

RBC [S 96 LWX](#)

SMITH BEARING [CR 3 XBE](#)