

CR 3 XBE SMITH BEARING

Cam followers

TYPE: Roller bearings, Stud type track rollers, Eccentric stud, hex socket, contact seals on both side, cylindrical outer ring, inch size

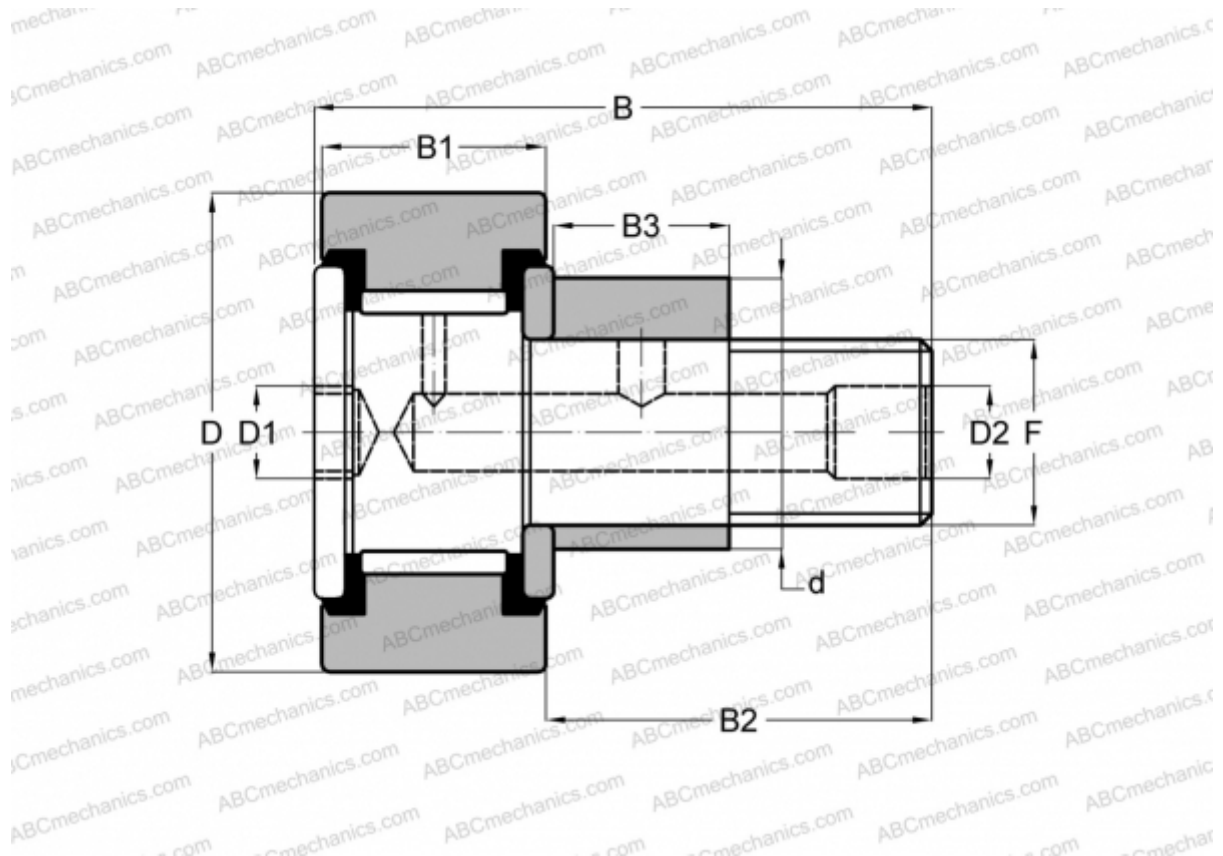

Technical specification

DIMENSIONS, MM

d	44,450
D	76,200
D1	15,875
D2	6,350
B	108,742
B1	44,450
B2	63,500
B3	31,750
F	1 1/4-12

INTERCHANGE

INA	CFE 48 PP
McGill	CFE 3 SB
RBC	S 96 LWX

WEIGHT, KG 2,000

MANUFACTURER [SMITH BEARING](#)

INTERCHANGE [TORRINGTON CRSBE 48](#)