

## CR 3 1/4 XBE SMITH BEARING

Cam followers

TYPE: Roller bearings, Stud type track rollers, Eccentric stud, hex socket, contact seals on both side, cylindrical outer ring, inch size

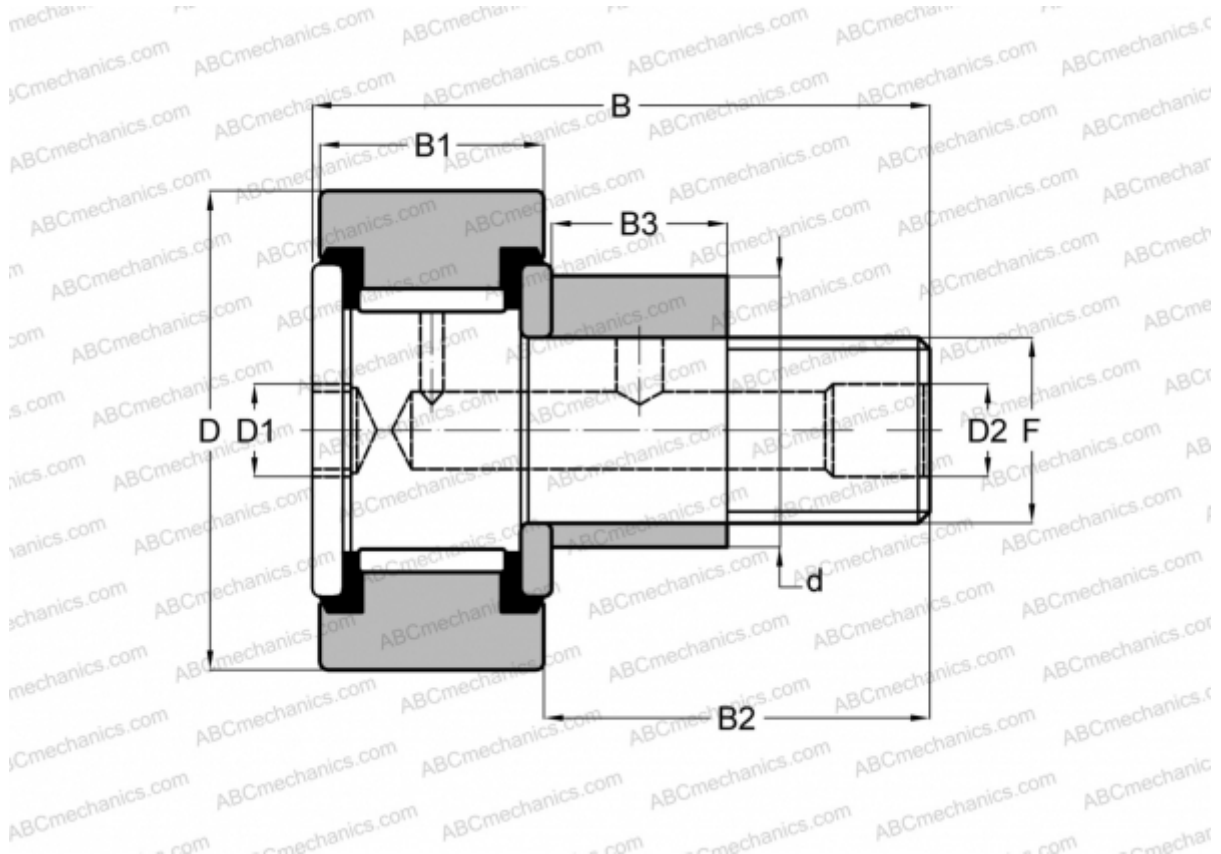

### Technical specification

#### DIMENSIONS, MM

d	44,450
D	82,550
D1	15,875
D2	6,350
B	108,742
B1	44,450
B2	63,500
B3	31,750
F	1 1/4-12

#### INTERCHANGE

INA	<a href="#">CFE 52 PP</a>
McGill	<a href="#">CFE 3 1/4 SB</a>
RBC	<a href="#">S 104 LWX</a>

**WEIGHT, KG** 2,295

**MANUFACTURER** [SMITH BEARING](#)

**INTERCHANGE** [TORRINGTON CRSBE 52](#)