

## FCR26 NSK

Cam followers

TYPE: Roller bearings, Stud type track rollers, With axial guidance, full complement bearing, outer ring has a cylindrical outside surface, type FCR (NSK)

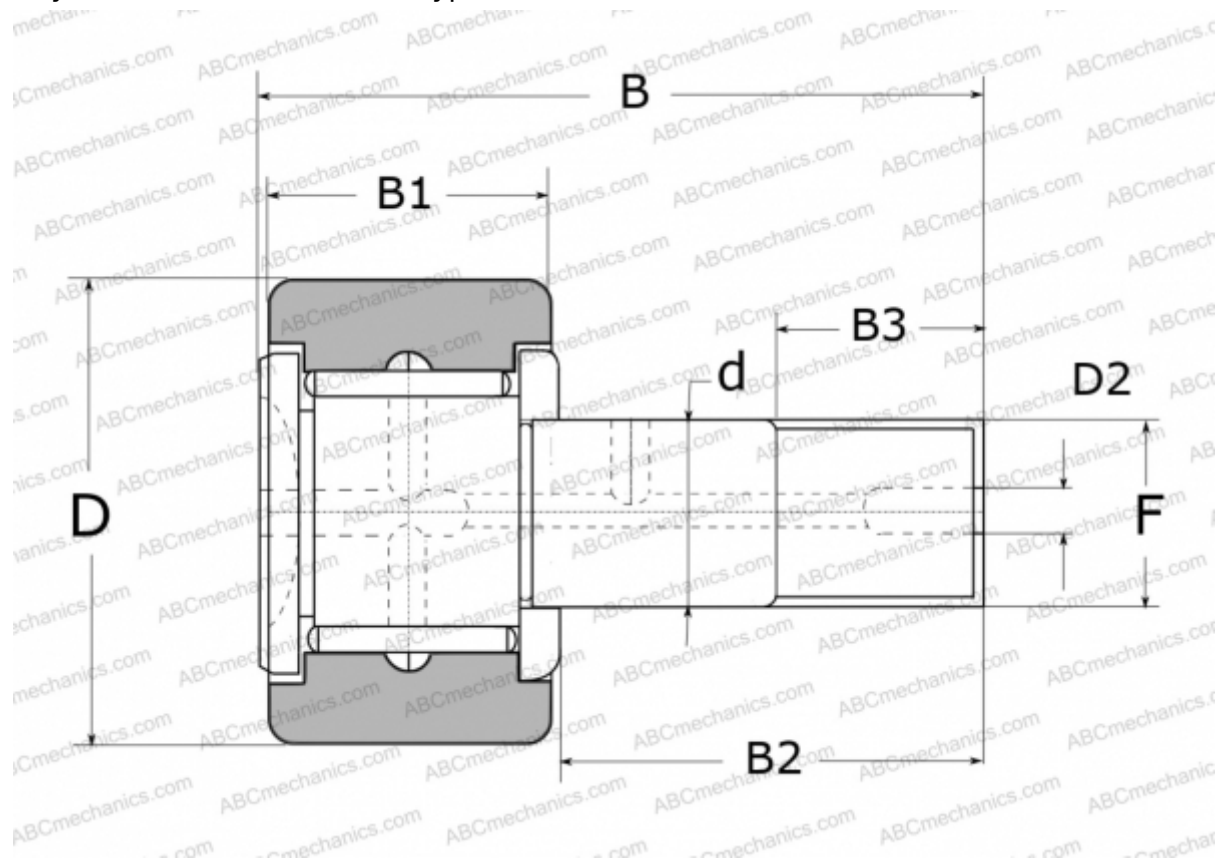

### Technical specification

#### DIMENSIONS, MM

d	10,000
D	26,000
D2	4,000
B	36,000
B1	12,000
B2	23,000
B3	12,000
F	M10X1.25

**WEIGHT, KG** 0,060

**MANUFACTURER** [NSK](#)

#### REPLACES

FCR-26