

## FCR40 NSK

Cam followers

TYPE: Roller bearings, Stud type track rollers, With axial guidance, full complement bearing, outer ring has a cylindrical outside surface, type FCR (NSK)

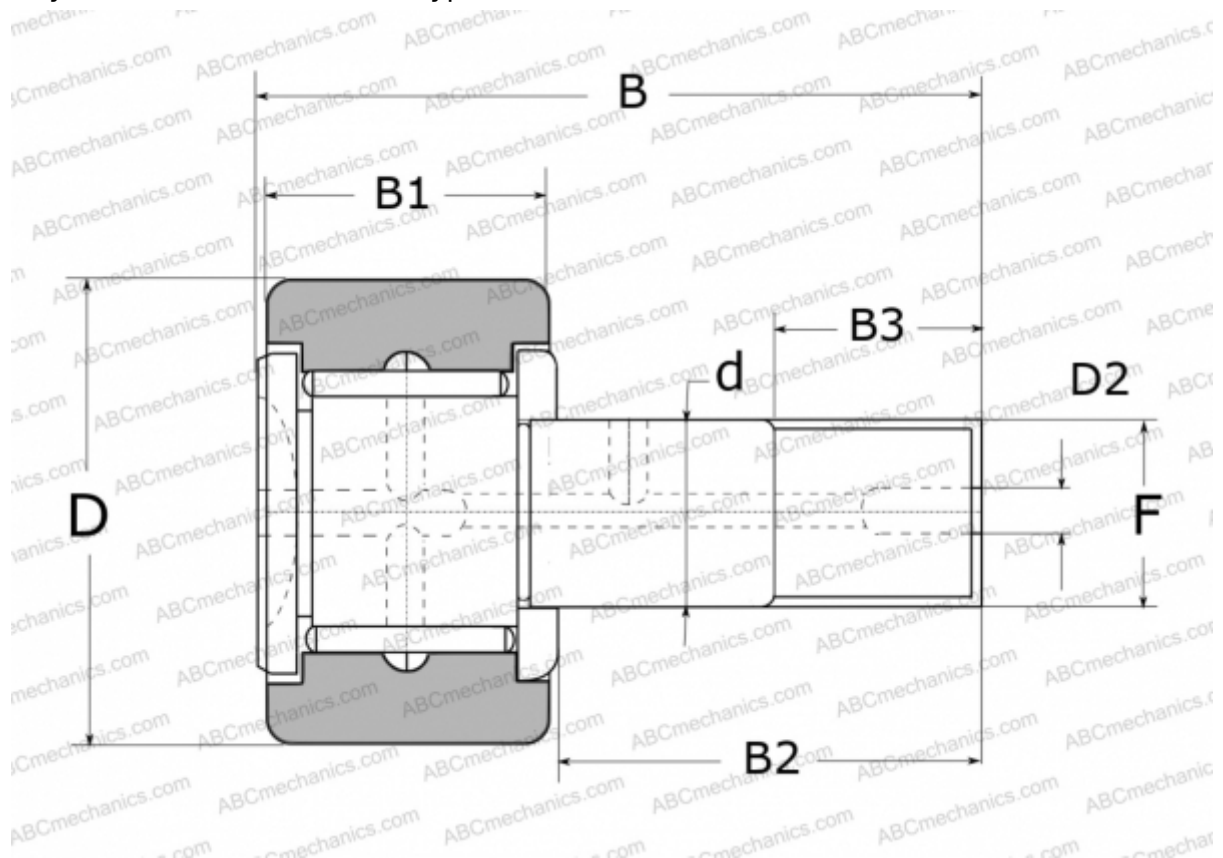

### Technical specification

#### DIMENSIONS, MM

d	18,000
D	40,000
D2	6,000
B	58,000
B1	20,000
B2	36,500
B3	19,000
F	M18X1.5

**WEIGHT, KG** 0,250

**MANUFACTURER** [NSK](#)

#### REPLACES

FCR-40