

CR56R NSK

Cam followers

TYPE: Roller bearings, Stud type track rollers, With axial guidance, full complement bearing, outer ring has a spherical outside surface, type CR..R (NSK), inch size

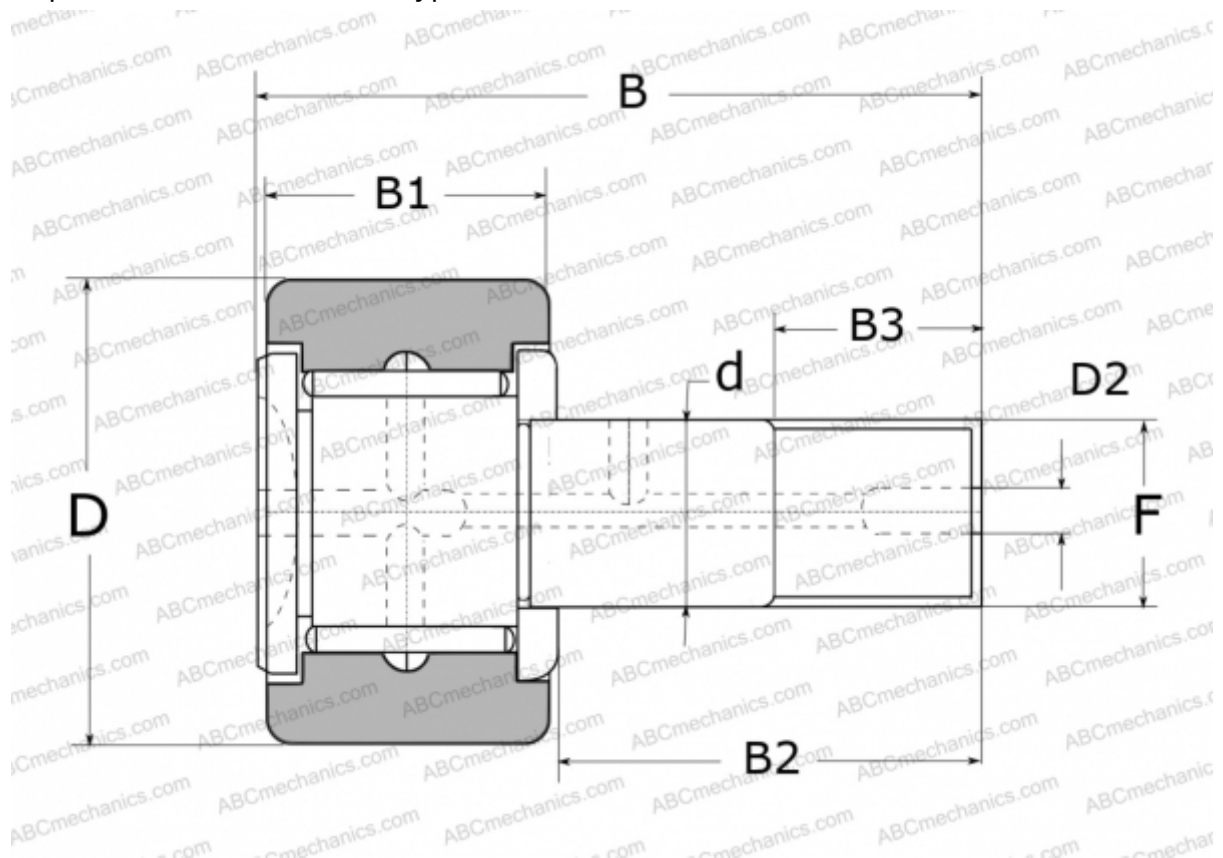

Technical specification

DIMENSIONS, MM

d	34,925
D	88,900
D2	6,400
B	122,300
B1	50,800
B2	69,850
B3	34,900
F	1 3/8-12

WEIGHT, KG 2,900

MANUFACTURER [NSK](#)

REPLACES

CR-56 R