

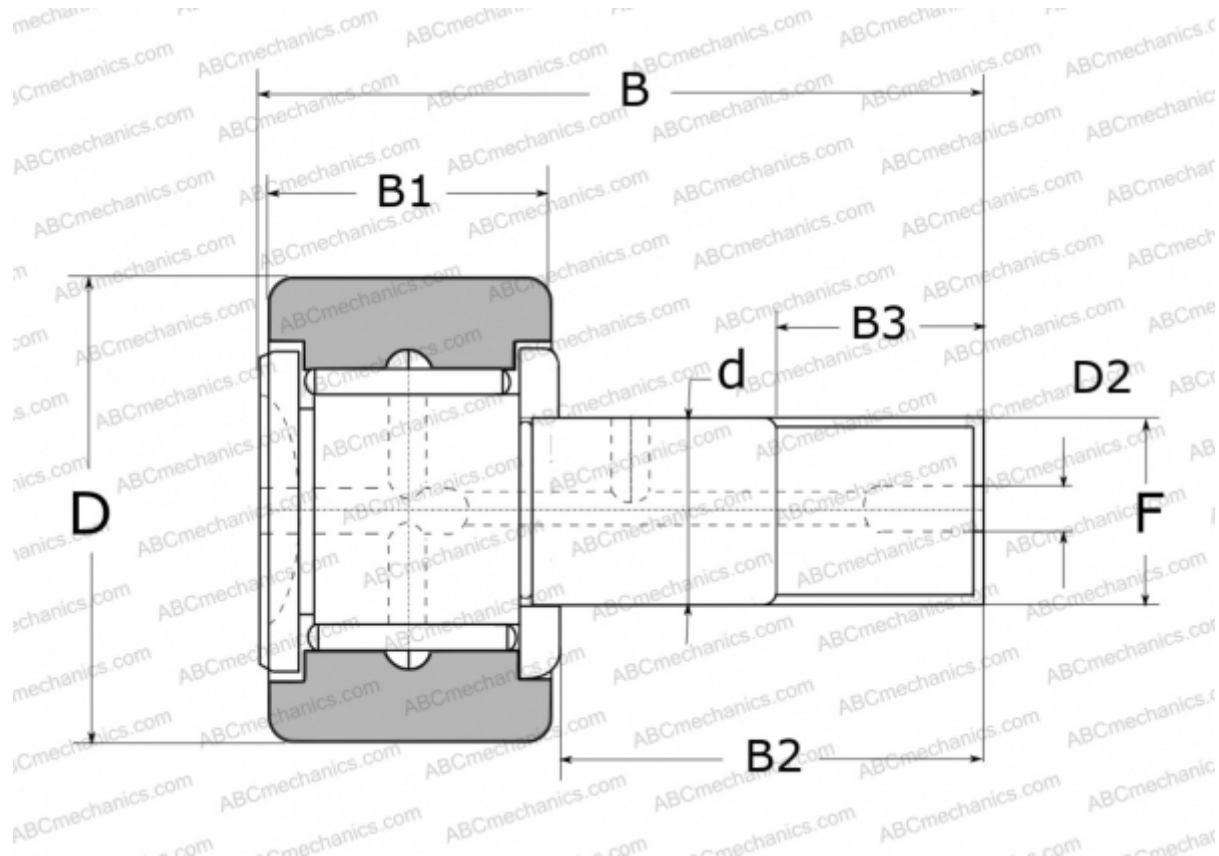

## CR12 NSK

Cam followers

TYPE: Roller bearings, Stud type track rollers, With axial guidance, full complement bearing, outer ring has a cylindrical outside surface, type CR (NSK), inch size



### Technical specification

#### DIMENSIONS, MM

d	9,525
D	19,050
D2	4,800
B	36,100
B1	12,700
B2	22,220
B3	9,500
F	3/8-24

**WEIGHT, KG** 0,034

**MANUFACTURER** [NSK](#)

#### REPLACES

CR-12

