

CRS32R NSK

Cam followers

TYPE: Roller bearings, Stud type track rollers, With axial guidance, full complement bearing, with seal, with thrust washer, outer ring has a spherical outside surface, type CRS..R (NSK), inch size

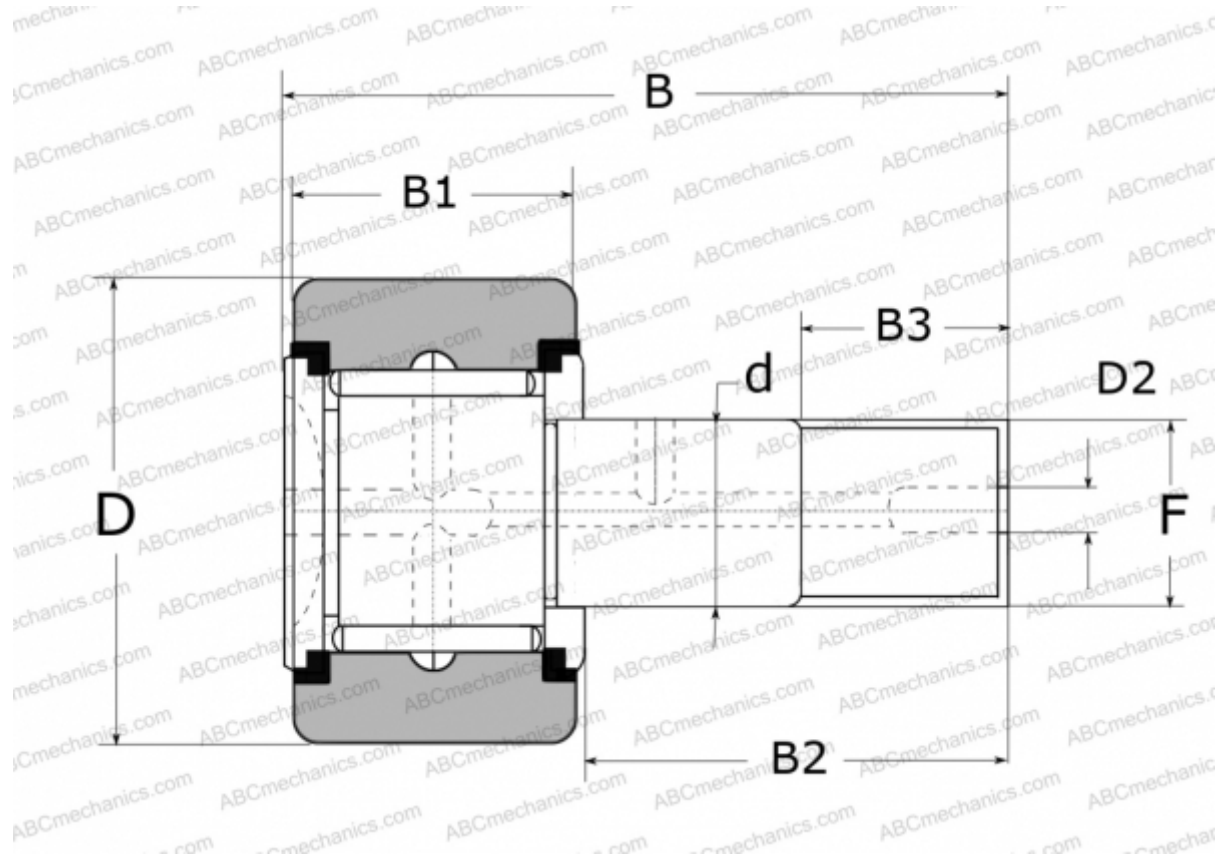

Technical specification

DIMENSIONS, MM

d	22,225
D	50,800
D2	4,800
B	83,900
B1	31,750
B2	50,800
B3	25,400
F	7/8-14

WEIGHT, KG 0,620

MANUFACTURER [NSK](#)

REPLACES

CRS-32 R