

527184V FAG

TYPE: Roller bearings, Tapered, Thrust, For screw down mechanisms, design 4 (FAG)

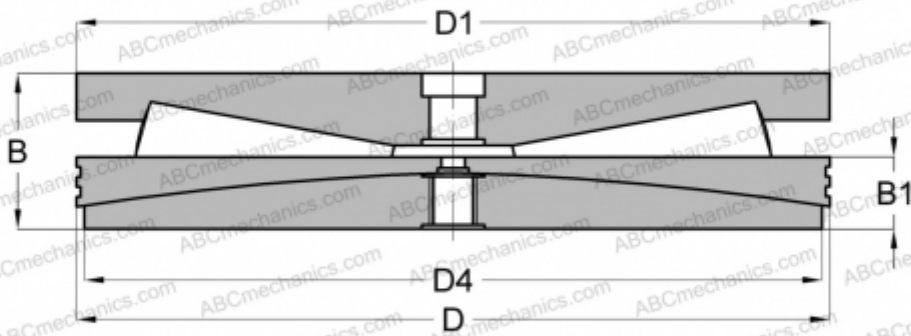

Technical specification

DIMENSIONS, MM

D	800,000
D1	800,000
D4	740,000
B	320,000
B1	175,000

WEIGHT, KG 1100,000

MANUFACTURER [FAG](#)